

REV.	SPECIFICATION	ECN NO.	APPD.
R13		ECN220604	

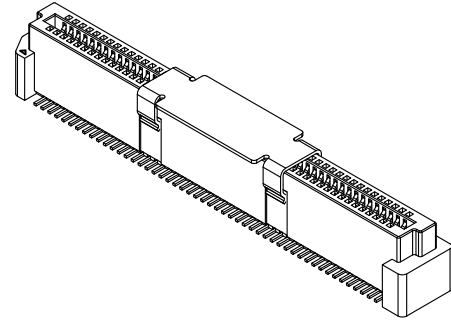
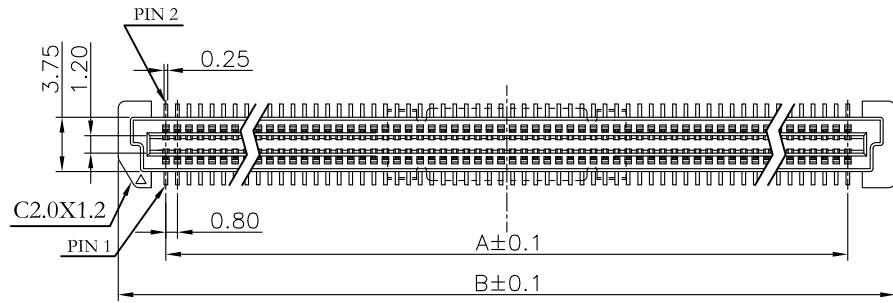

Material and Plating:

Housing: LCP , UL94V-0 , Natural Color .
 Signal Contacts : Phosphor Bronze .
 Gold Planted on contact Area and 80u" min Tin or Gold
 Flash plated on solder tail over 50u" min Nickel

Electrical Characteristics:

Current Rating: 0.5 AMP.
 Dielectric Withstanding Voltage: AC 500V For 1 minute.
 Insulator Resistance: 500MΩ min. at DC 250V.
 Contact Resistance: 30mΩ max. at DC 100mA. >
 Operating Temperature: -45°C~+125°C.

***RoHS Compliant**

Stacked Height

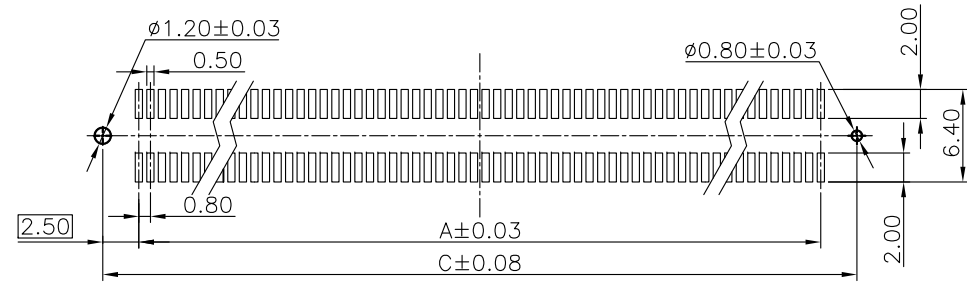
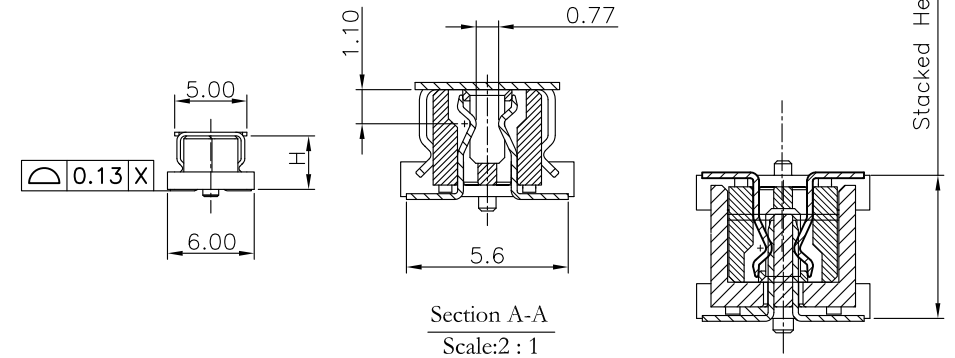
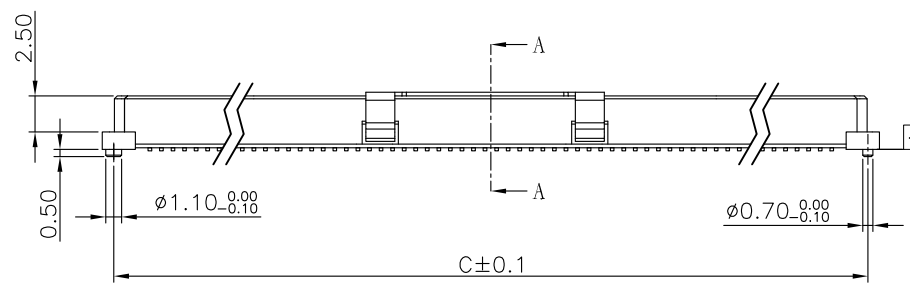

P.C. Board Layout
(Tolerance:±0.05)

Series **2382-** xx C xx D P x T - M
 Position
 G: Gold Plated
 C: Selective Gold Plated
 00: G/F
 10: 10 μ"
 30: 30 μ"
 M: Metal Cap
 T: Tape & Reel Package
 Code 1~2
 P: With Post
 N: Without Post
 D: SMD Type

"*" Available Position					
Code		Pos.	Dimension		
H1	H2		A	B	C
*	*	60	23.20	29.80	28.20
*	*	80	31.20	37.80	36.20
*	*	100	39.20	45.80	44.20
*	*	120	47.20	53.80	52.20
*	*	140	55.20	61.80	60.20

Code	1				2			
Height(H)	3.70				7.70			
Height(Y)	5.0	6.0	7.0	8.0	9.0	10.0	11.0	12.0

Tolerances	Dwg.No.	2382-D0000-001		Title:	2382 Series Board to Board 0.8mm Female Type				
x = ±0.5	Projection	⊕ ⊖		Drawn By	ZY 06/02'22	SHEET	1/1	Ver.No.	R13
.x = ±0.25	Unit	mm	Scale						
.xx = ±0.15	Scale								

OUPIN
OUPIN ELECTRONIC(KUNSHAN) CO., LTD.
 P/N: 2382-xxCxxDPxT-M