

## SMD Nonshielded type

### ▼ Shape & Dimensions / Recommended Solder Land Pattern

(Dimensions in mm)

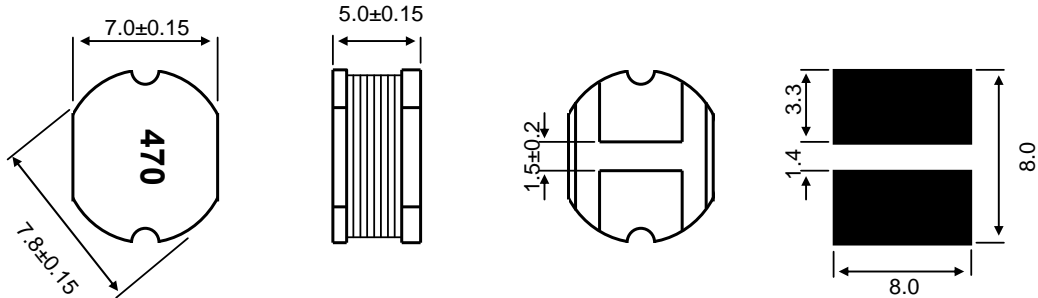

### ▼ Electrical Characteristics

Ordering Code	Inductance		Freq.	DC Resistance(Ω)	Rated DC current(A)
	L (uH)	Tol. (%)	F (KHz)	Rdc (Max.)	
LPN7850T-100K	10	±10	100	0.07	2.30
LPN7850T-150K	15			0.09	1.80
LPN7850T-220K	22			0.11	1.50
LPN7850T-330K	33			0.13	1.30
LPN7850T-470K	47			0.18	1.10
LPN7850T-680K	68			0.28	0.85
LPN7850T-101K	100			0.43	0.72
LPN7850T-151K	150			0.64	0.58
LPN7850T-221K	220			0.96	0.49
LPN7850T-331K	330			1.26	0.40
LPN7850T-471K	470	1.96	0.34		

### ▼ Test Equipments

- . L : Agilent E4980A Precision LCR Meter
- . Rdc : HIOKI 3540 mΩ HiTESTER
- . Idc : Agilent 4284A LCR Meter + Agilent 42841A Bias Current Source

### ▼ Test Condition

- . L(Frequency , Voltage) : F=100 (KHz) , V=0.5 (V)
- . Idc(The saturation current) :  $\Delta L \leq 10\%$  typical at rated current
- ※ Rated DC current : Idc

### ▼ Operating Temperature Range

-20 ~ +85 °C (Including self-generated heat)