

Datasheet

# LL01CR-CHQxxLxx

## Available Distribution

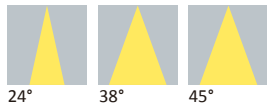

## LED

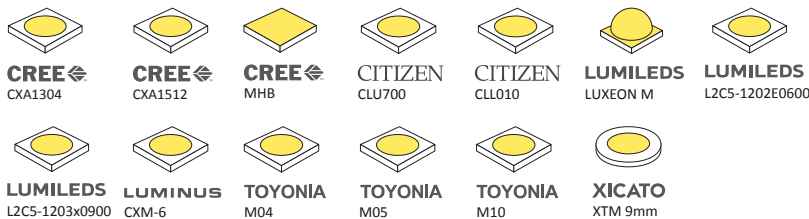

## Recommend Applications



## General Information



- Lens Material            L02: PC LEV1700 (RTI: 90°C) / L52: PC 2180T (RTI: 125°C)
- Operating Temperature    -40°C~+110°C
- Light Transmission Rate    400nm~900nm > 90%
- ☑ If necessary, Clean lenses with mild soap, water and soft cloth.
- ⚠ Never use any commercial cleaning solvents on lenses, like alcohol.
- ⚠ Please handle or install lenses with wearing gloves, skin oils may damage lens or its optical characteristic.

## Dimensions

Part Number	Diameter	Height
LL01CR-CHQxxLxx	Ø35	10.5

\*All dimensions are in millimeters.

## Packaging Details (SPQ)

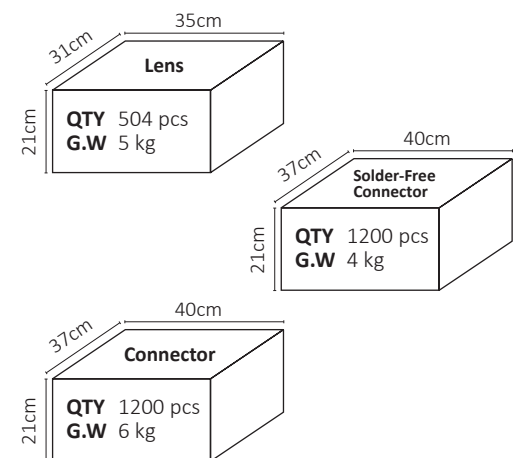

## Accessories



- Available with Connector  
LL01A00CSLB2 (CREE CXA1512)
- Available with Solder-Free Connector  
LL01A00CWFB2 (CREE CXA1304)  
LL01A00CWGB2 (Citizen CLU700 / Luminus CXM-6)

# Mechanical Specification

\*All dimensions are in millimeters.

## Lens Dimension

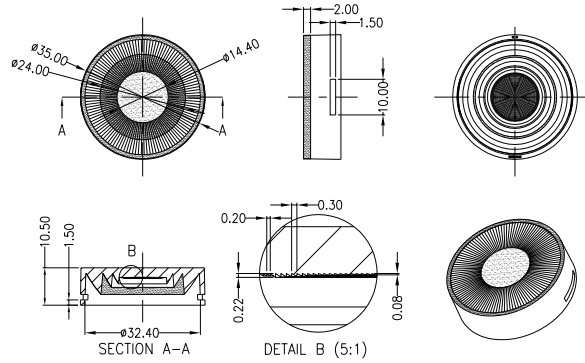

## Solder-Free Connector Dimension



LL01A00CWFB2

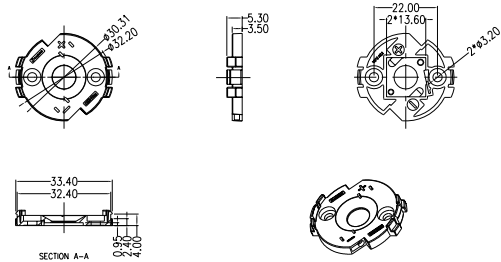

## Assembly Instruction

Fixing Method

Part No LL01CR-CHQxxLxx  
 Connector LL01A00CWFB2  
 LED CREE CXA1304

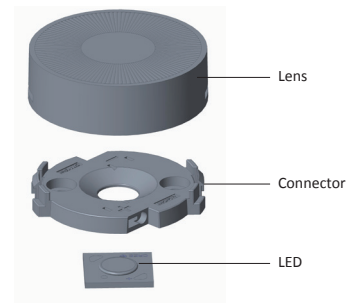

## Solder-Free Connector Dimension



LL01A00CWGB2

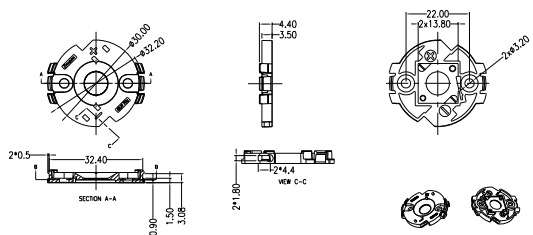

## Assembly Instruction

Fixing Method

Part No LL01CR-CHQxxLxx  
 Connector LL01A00CWGB2  
 LED Citizen CLU700 / LUMINUS CXM-6

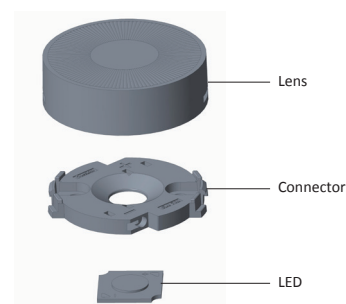

## Connector Dimension



LL01A00CSLB2

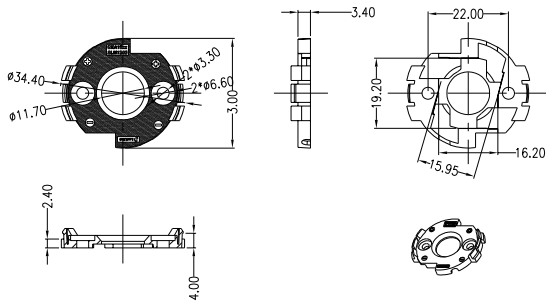

## Assembly Instruction

Fixing Method

Part No LL01CR-CHQxxLxx  
Connector LL01A00CSLB2  
LED CREE CXA1512

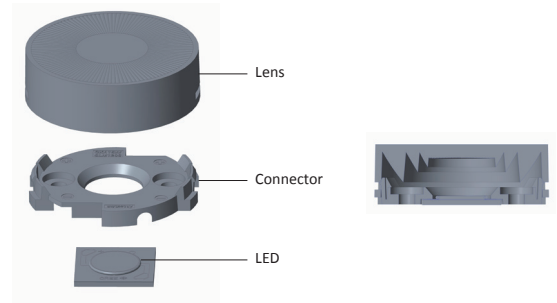

## Assembly Instruction

Fixing Method

Part No LL01CR-CHQxxLxx  
LED TOYONIA M10-H-30H / M05-H-30J1  
LUMILEDS LUXEON M

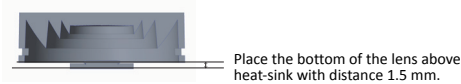
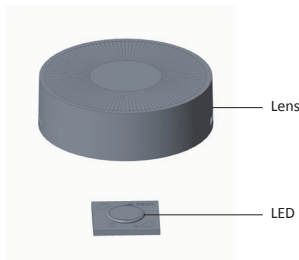

## Assembly Instruction

Fixing Method

Part No LL01CR-CHQxxLxx  
LED CITIZEN CLL010  
LUMILEDS Luxeon L2C5-1202E0600  
LUMILEDS Luxeon L2C5-1203x0900

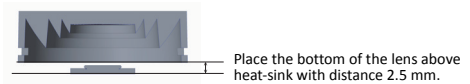
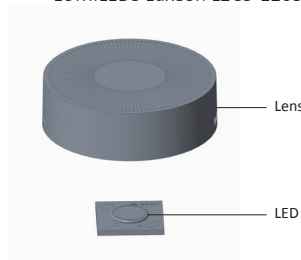

## Assembly Instruction

Fixing Method

Part No LL01CR-CHQxxLxx  
LED TOYONIA M04-H-27GB

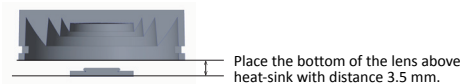
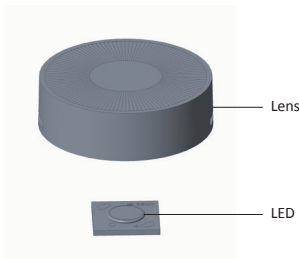

## Assembly Instruction

Fixing Method

Part No LL01CR-CHQxxLxx  
LED Xicato XTM-9mm

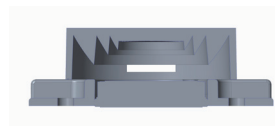
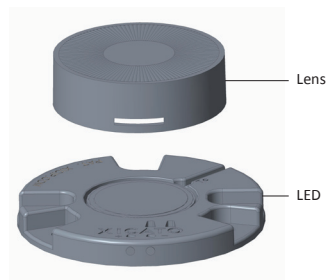

# Photometric Distribution

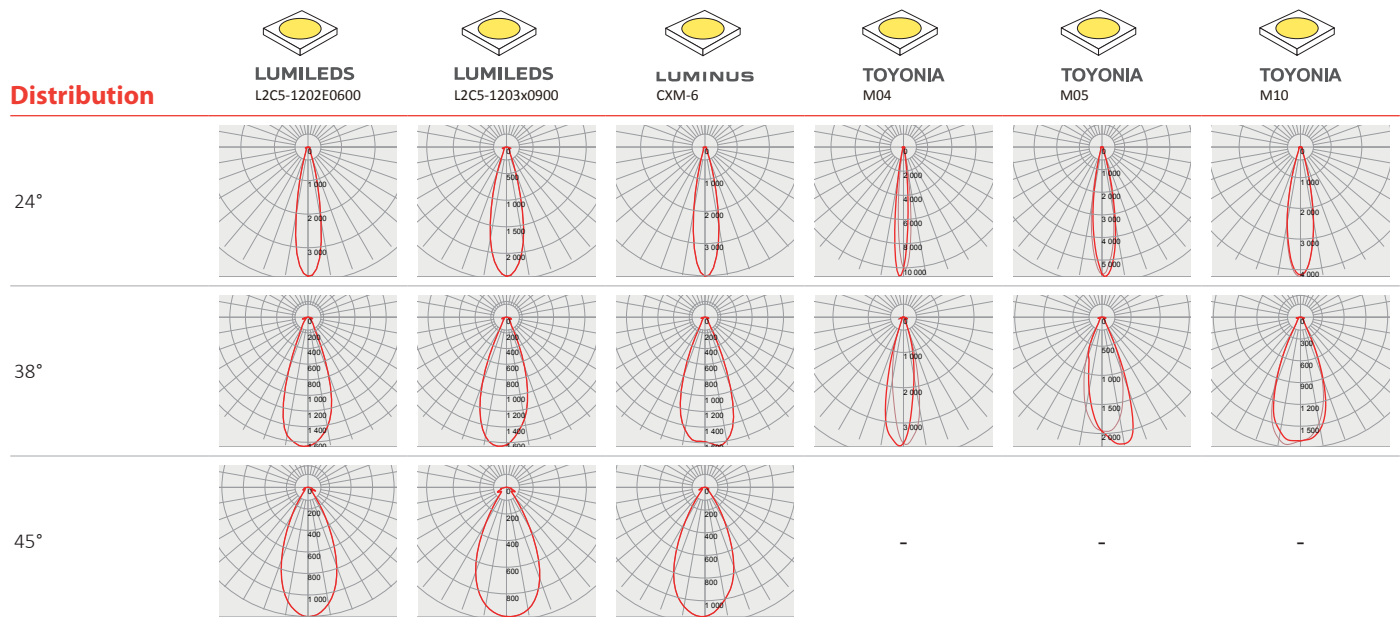
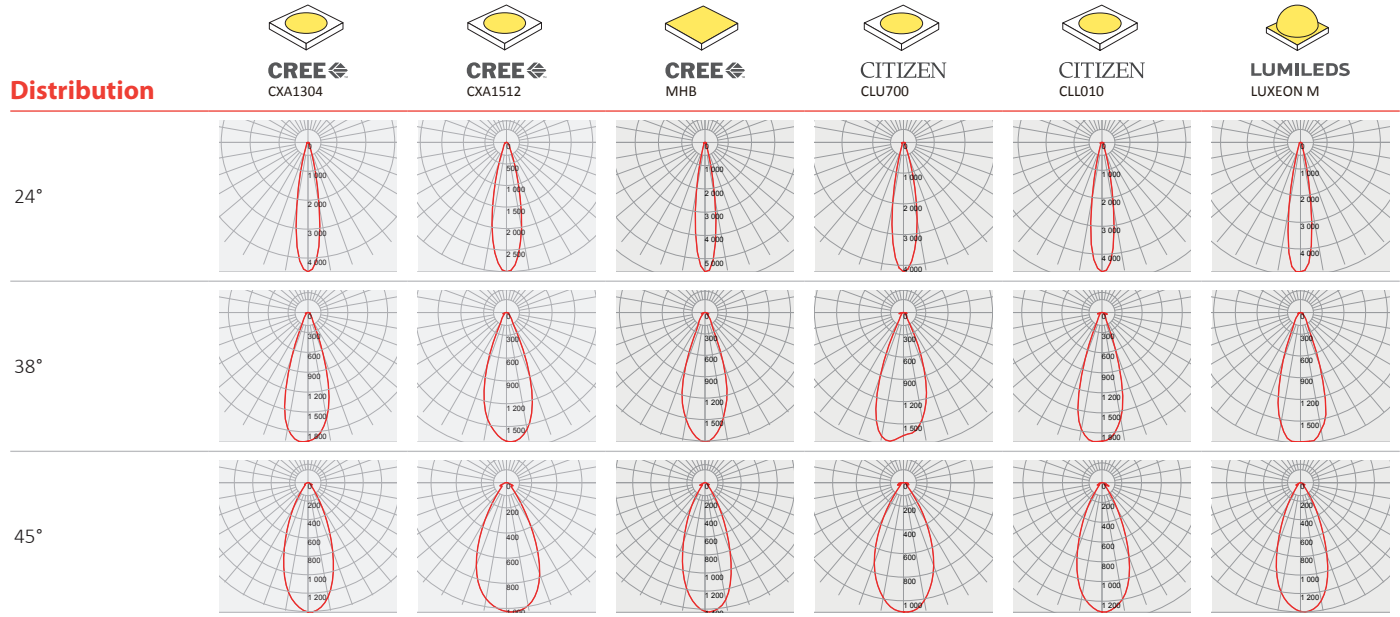

# Photometric Distribution



**XICATO**  
XTM 9mm

## Distribution

---

24°

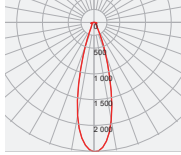



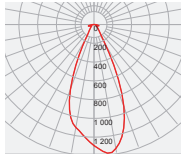

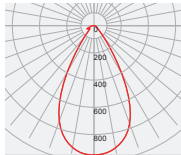

38°



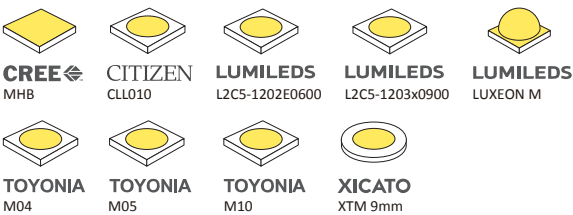

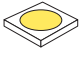

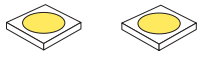

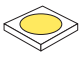



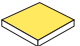

45°



# Details by LED

Part No	Connector	LED Package Size	LED
LL01CR-CHQxxLxx	-	LES $\varnothing$ 2.8~9	 <b>CREE</b> MHB <b>CITIZEN</b> CLL010 <b>LUMILEDS</b> L2C5-1202E0600 <b>LUMILEDS</b> L2C5-1203x0900 <b>LUMILEDS</b> LUXEON M <b>TOYONIA</b> M04 <b>TOYONIA</b> M05 <b>TOYONIA</b> M10 <b>XICATO</b> XTM 9mm
		 LES $\varnothing$ 6	 <b>CREE</b> CXA1304
		 LES $\varnothing$ 6~7.8	 <b>CITIZEN</b> CLU700 <b>LUMINUS</b> CXM-6
		 LES $\varnothing$ 9	 <b>CREE</b> CXA1512

LED	Part No	FWHM	cd / lm	IES
 <b>CREE</b> CXA1304	LL01CR-CHQ24L02	19°	4.4	↓
	LL01CR-CHQ38L02	35°	1.9	↓
	LL01CR-CHQ45L52	42°	1.4	↓
 <b>CREE</b> CXA1512	LL01CR-CHQ24L02	25°	3.0	↓
	LL01CR-CHQ38L02	39°	1.7	↓
	LL01CR-CHQ45L52	51°	1.0	↓
 <b>CREE</b> MHB	LL01CR-CHQ24L02	17°	5.5	↓
	LL01CR-CHQ38L02	37°	1.8	↓
	LL01CR-CHQ45L52	41°	1.4	↓
 <b>CITIZEN</b> CLU700	LL01CR-CHQ24L02	21°	4.2	↓
	LL01CR-CHQ38L02	39°	1.7	↓
	LL01CR-CHQ45L52	50°	1.0	↓
 <b>CITIZEN</b> CLL010	LL01CR-CHQ24L02	19°	4.6	↓
	LL01CR-CHQ38L02	34°	1.9	↓
	LL01CR-CHQ45L52	44°	1.3	↓
 <b>LUMILEDS</b> LUXEON M	LL01CR-CHQ24L02	19°	4.8	↓
	LL01CR-CHQ38L02	36°	1.7	↓
	LL01CR-CHQ45L52	42°	1.4	↓
 <b>LUMILEDS</b> L2CS-1202E0600	LL01CR-CHQ24L02	21°	3.8	↓
	LL01CR-CHQ38L02	38°	1.6	↓
	LL01CR-CHQ45L52	46°	1.2	↓
 <b>LUMILEDS</b> L2CS-1203x0900	LL01CR-CHQ24L02	27°	2.4	↓
	LL01CR-CHQ38L02	38°	1.6	↓
	LL01CR-CHQ45L52	52°	0.9	↓
 <b>LUMINUS</b> CXM-6	LL01CR-CHQ24L02	21°	4.0	↓
	LL01CR-CHQ38L02	40°	1.6	↓
	LL01CR-CHQ45L52	49°	1.1	↓
 <b>TOYONIA</b> M04	LL01CR-CHQ24L02	11°	10.7	↓
	LL01CR-CHQ38L02	23°	3.6	↓
	LL01CR-CHQ45L52	-	-	-
 <b>TOYONIA</b> M05	LL01CR-CHQ24L02	19°	5.7	↓
	LL01CR-CHQ38L02	33°	2.2	↓
	LL01CR-CHQ45L52	-	-	-
 <b>TOYONIA</b> M10	LL01CR-CHQ24L02	22°	4.2	↓
	LL01CR-CHQ38L02	42°	1.7	↓
	LL01CR-CHQ45L52	-	-	-
 <b>XICATO</b> XTM 9mm	LL01CR-CHQ24L02	28°	2.5	↓
	LL01CR-CHQ38L02	44°	1.3	↓
	LL01CR-CHQ45L52	56°	0.9	↓

## Product Nomenclature

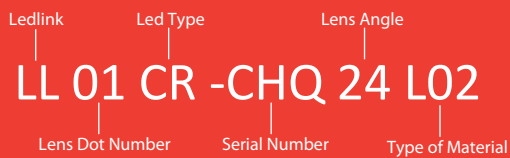

### Ledlink Optics, Inc Taiwan HQ

15F, No.655, Bannan Rd., Chung-Ho Dist.,  
New Taipei City, Taiwan 235

### Ledlink Optics (Dongguan) Co., Ltd Dongguan Factory

No.5, TianKeng Industrial Dist., HengLiTown, DongGuan City,  
GuangDong Province, China 523478

### Ledlink Optics (Yangzhou) Co., Ltd Yangzhou Factory

No.180, LinJiang Rd., YangZhou City, Jiangsu Province, China 225009

[www.ledlink-optics.com](http://www.ledlink-optics.com)

[service@ledlink-optics.com](mailto:service@ledlink-optics.com)





# Mouser Electronics

Authorized Distributor

Click to View Pricing, Inventory, Delivery & Lifecycle Information:

[LedLink Optics:](#)

[LL01CR-CHQ38L02](#) [LL01CR-CHQ24L02](#) [LL01A00CSLB2](#) [LL01A00CWGB2](#) [LL01A00CWFB2](#)