

# KFH-M4-12ET-

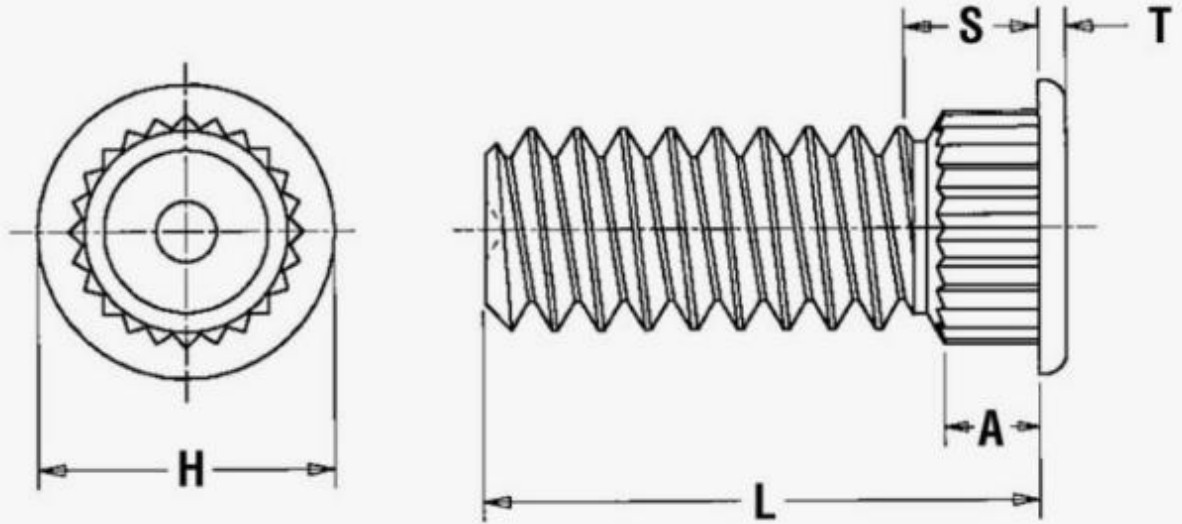

THREAD SIZE X PITCH	M4 x 0.7	A SHANK MAX	1.65mm
THREAD SPECIFICATION	6g, ASME B1.13M, External	H PLUS MINUS 0.25 MM	5.74mm
FASTENER MATERIAL	CDA-510 Phosphor Bronze	HOLE SIZE IN SHEET + 0.08_MM	4.20mm
STANDARD FINISH	Annealed, ASTM B545, Class B with Preservative Coating, Electro-Plated Tin	L - LENGTH $\pm$ 0.25_MM	12mm
FOR USE IN SHEET HARDNESS	HRB 55 / HB 83 or Less PC Board	MAX. HOLE SIZE IN ATTACHED PARTS_MM	4.80mm
PRODUCT CATEGORY	Broaching Studs - Type KFH	MIN. DIST. HOLE C/L TO EDGE_MM	5.1mm
CAD SUPPLIER	PennEngineering* (PEM*)	MIN. SHEET THICKNESS_MM	1.53mm
CADPARTID	103745	S MAX_MM	2.30mm
APPLICATION TYPE	Automotive, Automotive Electronics, Datacom, Telecom	T $\pm$ 0.13_MM	0.51mm
BASE PANEL MATERIAL	PC Board		
BRAND	PEM		