

| P | LTR | DESCRIPTION | DATE | DWN | APVD |
|----|-----|------------------------------|-----------|-----|------|
| A | | NEW DRAWING | 03AUG2016 | MT | GCR |
| A1 | | UPDATED AS PER ECR-20-014900 | 06AUG2020 | SK | GSM |
| - | - | - | - | - | - |
| - | - | - | - | - | - |

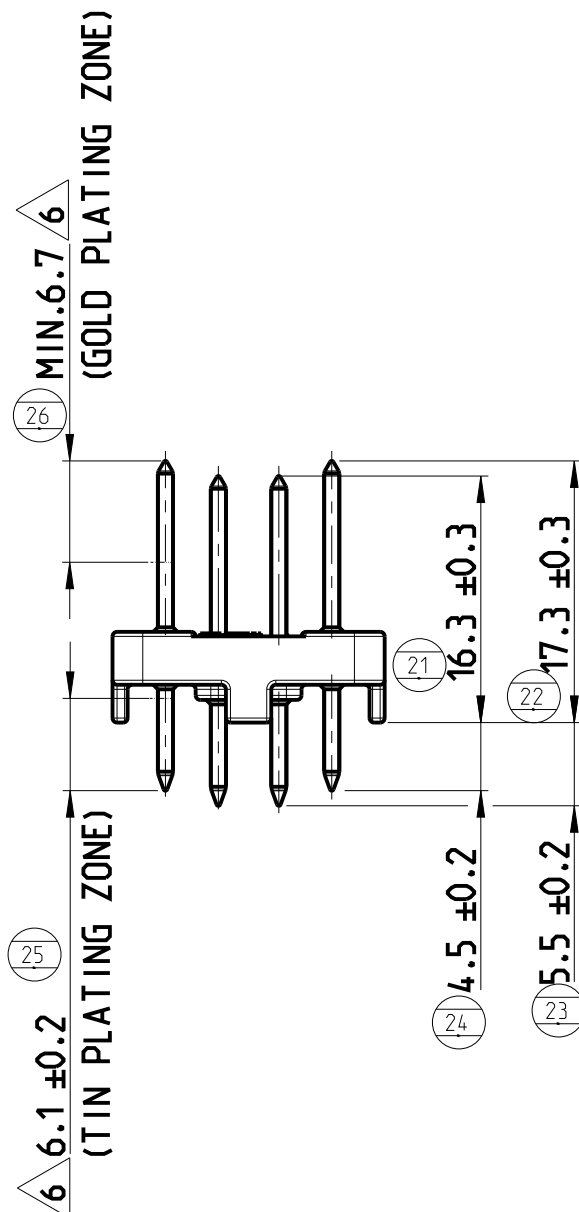

NOTES:

- 1 TE CONNECTIVITY (TE) LOGO.
- 2 TE PART-NO.
- 3 LETTER-INSERT FOR THE REVISION STATUS OF THE MOULD
ACTUAL STATUS: SEE TABLE
- 4 MATERIAL MARKING ACCORDING TO VDA 260
- 5 PRODUCTION DATE
- 6 PLATING : GOLD PLATING 0.4 μm MIN.
TIN PLATING. 2.5~5 μm
UNDER PLATING : NICKEL PLATING 1.3~2.5 μm.
- 7 TUBE PACKAGING IN CORRUGATED BOX

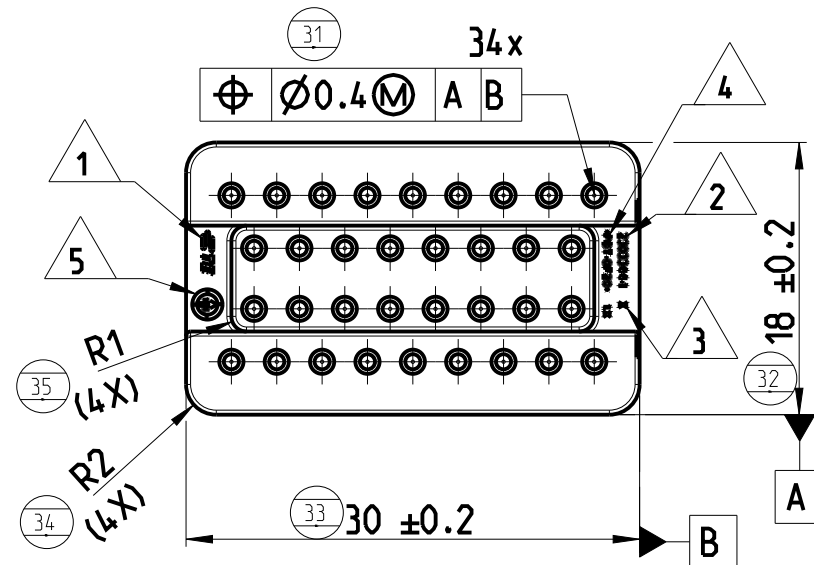
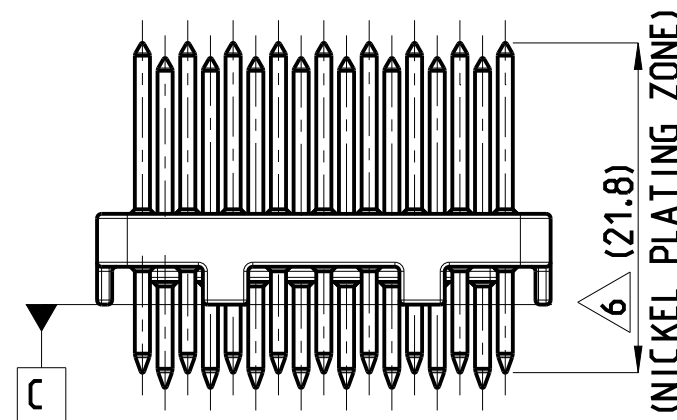
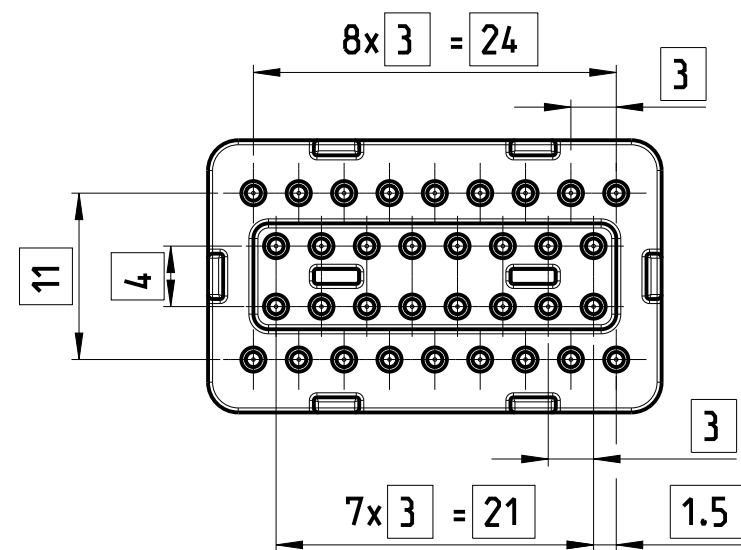
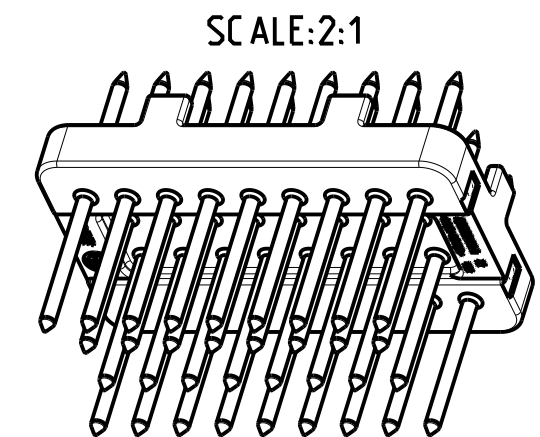

2303344-1, AS SHOWN
PIN CARRIER 34P.



| TE ORDER-NO. | DESCRIPTION | REV. | QTY | MATERIAL | COLOUR | DESCRIPTION | ITEM |
|--------------|-----------------|------|-----|-------------|-------------|-------------|------|
| 2303344-2 | PIN CARRIER 26P | A1 | 26 | C2600/C2700 | PLATING: Au | PIN | 2 |
| | | | - | PBT-GF20 | BLACK | Body | |
| 2303344-1 | PIN CARRIER 34P | A1 | 34 | C2600/C2700 | PLATING: Au | PIN | 1 |
| | | | - | PBT-GF20 | BLACK | Body | |

| | |
|--|--|
| TOLERANCES UNLESS OTHERWISE SPECIFIED ACC. TO DIN 16901-140 @ CENTRIC TO NOMINAL DIMENSION. EDITION 1982-11 SHALL APPLY. Freissstoleranzen nach DIN 16901-140 @. Es gilt die Ausgabe 1982-11. | |
| PRODUCT CHARACTERISTICS ACC. QMP EMEA_12 BESONDERE MERKMALE NACH QMP EMEA_12 | TOLERANCING ISO 8015 TOLERIERUNG ISO 8015 |
| THIS DRAWING IS A CONTROLLED DOCUMENT. | DWN 09MAY2016 MANJUNATH GM |
| DIMENSIONING AND TOLERANCING PER GPS (ISO STANDARDS) | CHK 09MAY2016 GURUMURTHY CR |
| DIMENSIONS: mm | APVD 09MAY2016 V.V.BIDI |
| TOLERANCES UNLESS OTHERWISE SPECIFIED: 0 PLC ±0.1 1 PLC ±0.01 2 PLC ±0.001 3 PLC ±0.0001 4 PLC ANGLES ± | PRODUCT SPEC - APPLICATION SPEC - |
| MATERIAL TBD | WEIGHT 7.5g |
| FINISH SEE TABLE | CUSTOMER DRAWING |

| | | | |
|--------------------------|--------------------|-------------------------|--------|
| NAME PIN CARRIER. 34P | | RESTRICTED TO | |
| SIZE A3 | CAGE CODE 00779 | DRAWING NO C-2303344 | |
| SCALE 5:1 | | SHEET 1 OF 2 | REV A1 |

© 2020 TE Connectivity. All Rights Reserved.

REVISIONS

| P | LTR | DESCRIPTION | DATE | DWN | APVD |
|---|-----|-------------|------|-----|------|
| - | - | SEE SHEET 1 | - | - | - |
| - | - | - | - | - | - |
| - | - | - | - | - | - |
| - | - | - | - | - | - |

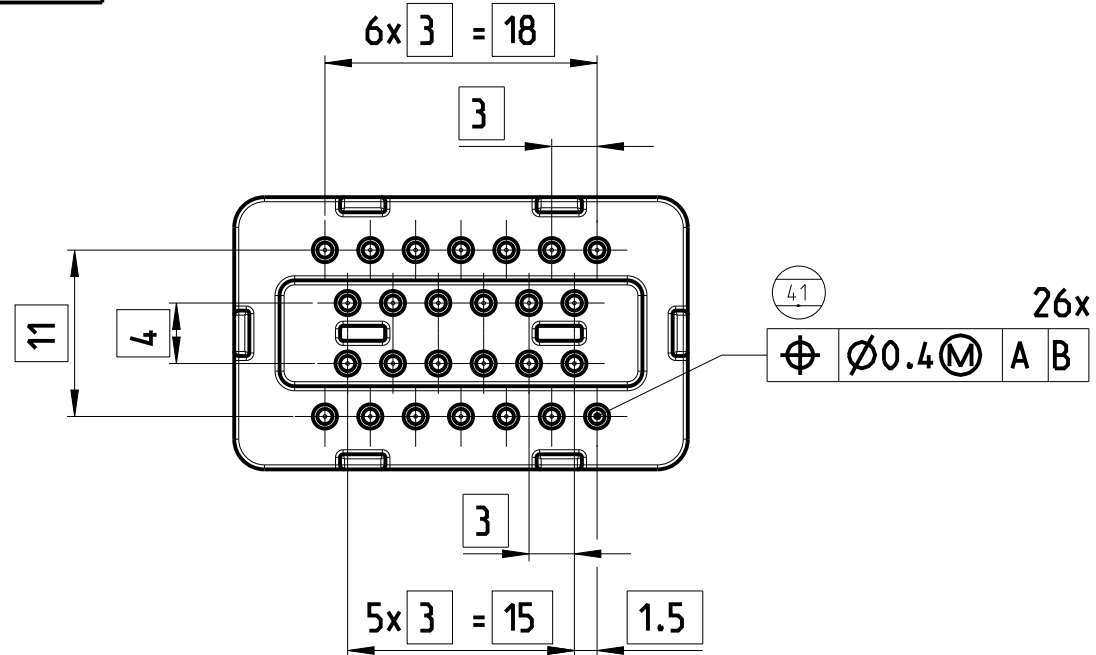

NOTES:

- 8 FOR DATUMS AND MISSING DIMENSION REFER 2303344-1, FROM SHEET 1.
- 9 FOR NOTES. SEE SHEET 1.

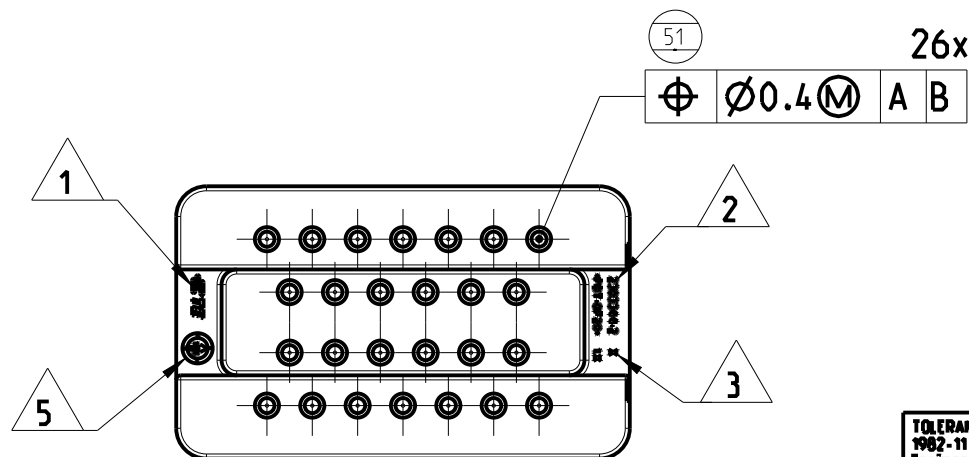
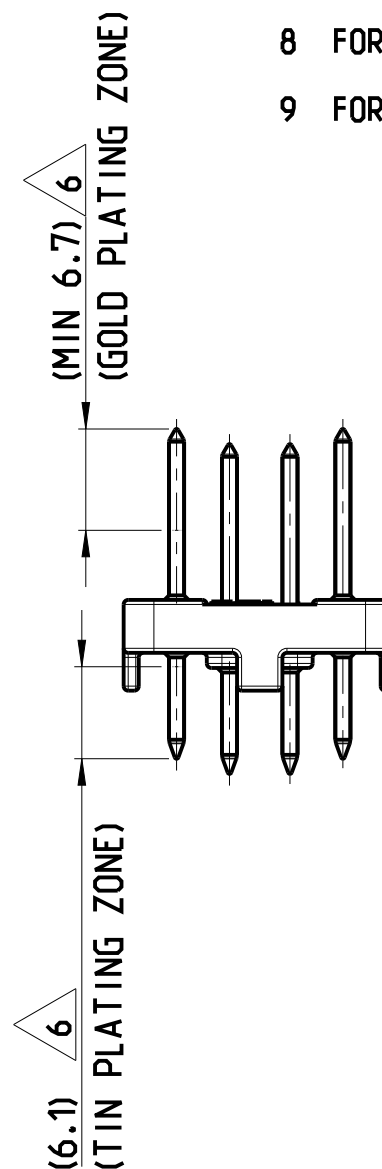
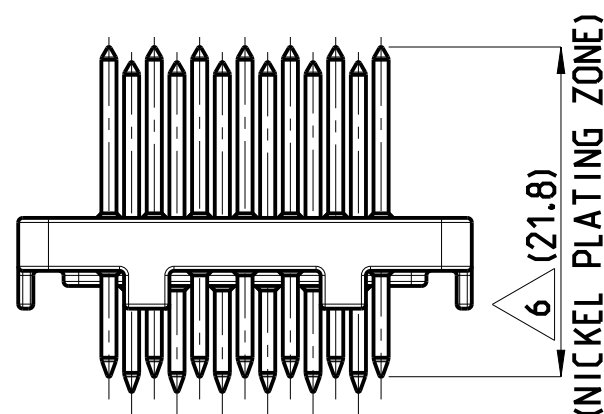

SCALE 2:1

2303344-2, AS SHOWN
PIN CARRIER 26P.

| | | | |
|---|--|--|--|
| TOLERANCES UNLESS OTHERWISE SPECIFIED ACC. TO DIN 16901-140 (D) CENTRIC TO NOMINAL DIMENSION. EDITION 1982-11 SHALL APPLY. Freissiztoleranzen nach DIN 16901-140 (D). Es gilt die Ausgabe 1982-11. | | TOLERANCING ISO 8015 TOLERIERUNG ISO 8015 | |
| PRODUCT CHARACTERISTICS ACC. QMP EMEA_12 BESONDERE MERKMALE NACH QMP EMEA_12 | | DWN 09MAY2016 MANJUNATH GM | |
| THIS DRAWING IS A CONTROLLED DOCUMENT. DIMENSIONING AND TOLERANCING PER GPS (ISO STANDARDS) | | CHK 09MAY2016 GURUMURTHY CR | |
| DIMENSIONS: mm | | APVD 09MAY2016 V V BIDI | |
| TOLERANCES UNLESS OTHERWISE SPECIFIED: | | PRODUCT SPEC | |
| 0 PLC ±0.1 | | - | |
| 1 PLC ±0.01 | | APPLICATION SPEC | |
| 2 PLC ±0.001 | | - | |
| 3 PLC ±0.001 | | WEIGHT 7.5g | |
| 4 PLC ±0.0001 | | MATERIAL TBD | |
| ANGLES ± | | FINISH SEE TABLE | |
| - | | - | |

| | | | |
|------------------|-----------|------------------|---------------------|
| | | NAME | |
| | | PIN CARRIER, 26P | |
| SIZE | CAGE CODE | DRAWING NO | RESTRICTED TO |
| A3 | 00779 | C-2303344 | |
| CUSTOMER DRAWING | | SCALE 5:1 | SHEET 2 OF 2 REV A1 |