

尺寸	0-1mm	1.01-5mm	5.01-15mm	15.01-50mm	>50mm	角度
公差	±0.1	±0.2	±0.3	±0.4	±0.5	±5°

MARKS	MODIFICATION	QTY.	CHK. BY	DATE

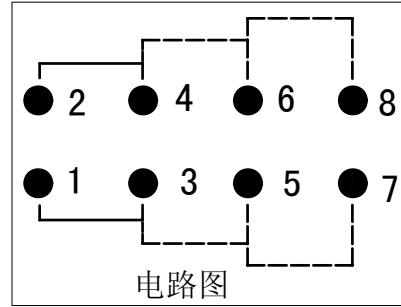
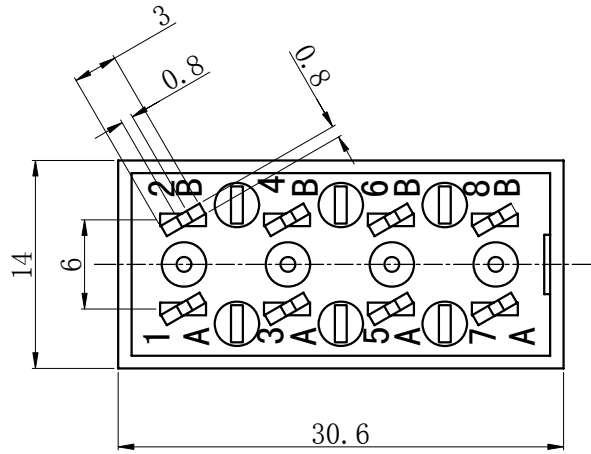

Rating: 10A 250VAC T85 (S, CQC)

13A 125VAC (UL CUL)

6.5A 250VAC (UL CUL)

Contact Resistance: 50mΩ (Max)

Insulation Resistance: 500VDC 100MΩ (Min)

Dielectric Strength: 1500VAC/1min

Electrical Life: 10000 Cycles

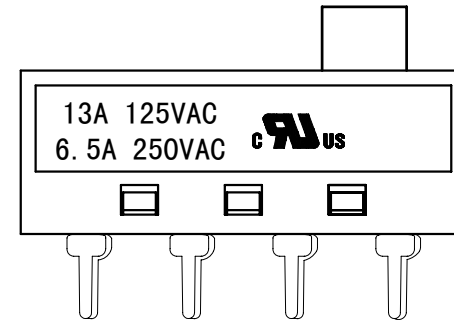
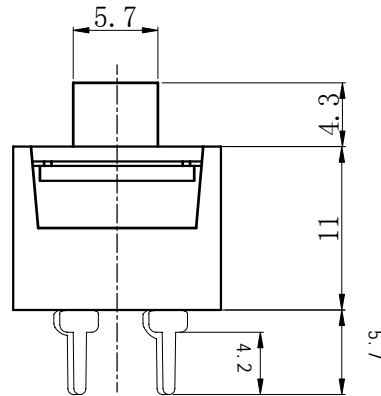
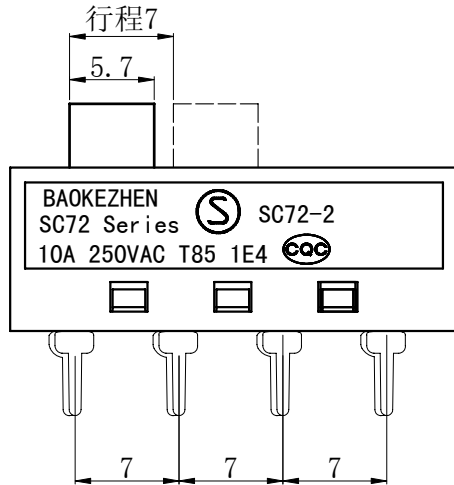

产品名称	跷板开关SC72	零部件图号	72-21AE4-AFZ-000-P	
零部件名称	外形图	版本	A0	材料
设计	黄雄阳 2020.07.09	单位	mm	比例 1:1
审核	温建平 2020.07.09	第 1 张 共 1 张		
批准	张铁勇 2020.07.09	东莞市研伦电气有限公司 DONGGUAN YANLUN ELECTRIC CO., LTD.		