

RoHS
COMPLIANT

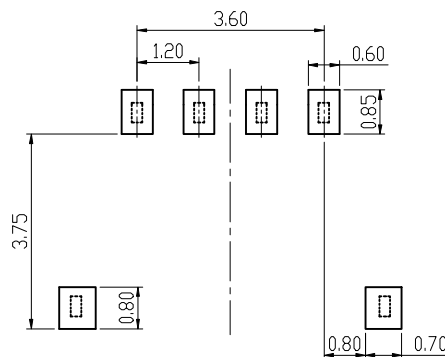

Recommended P. C. Board Layout

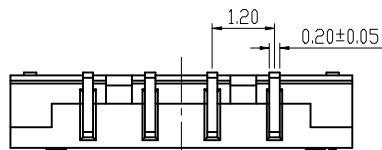
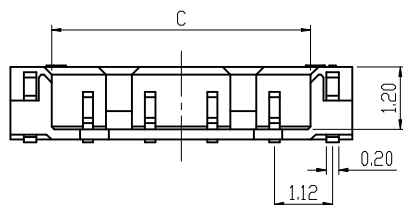
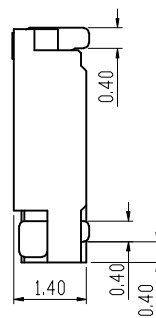
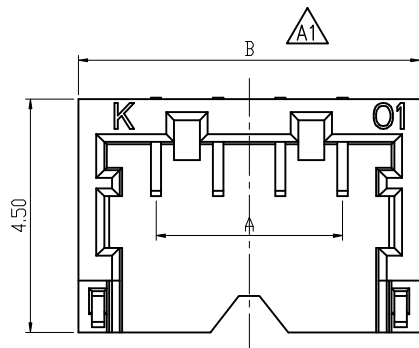

◆SPECIFICATIONS

- Current rating: 1.5A AC, DC
- Voltage rating: 50V AC,DC
- Temperature range: -40°C ~ +105°C
- Insulation resistance: 100MΩ Min.
- Withstanding voltage: 500V AC/ minute.
- Contact resistance: 20mΩ Max.

Material:

Insulator: PA9T/LCP UL 94V-0 Black
Contact: Phosphor bronze
Fitting Nail: Brass

Plating:

Contact: Gold Flash plated
Fitting Nail: Tin plated

Circuits: 2-8

PIN.	Dimension		
	A	B	C
2P	1.20	4.30	2.64
3P	2.40	5.50	3.84
4P	3.60	6.70	5.04
5P	4.80	7.90	6.24
6P	6.00	9.10	7.44

F				TOLERANCE	TITLE:	DRAWN: <i>ru yi 2020.03.10</i>	NINGBO KLS ELECTRONIC CO.,LTD		
		更改料号及图框格式	Ru yi	2020.3.10		CHECKED:			
		按实物修改B号尺寸,系列P77尺寸加0.10	王银敏	2025.4.29	X.X ±0.30 X.XX ±0.20 X.XXX ±0.10 Angle ±2°		APPROVED:	PART NO. L-KLS1-XL1-1.20-02-M1-W	
	MARK	REVISION DESCRIPTION	SIGNATURE	DATE	UNIT:mm	SCALE:N/A	SHEET: 1/1	PROJECTION	REV.: A2