

**Appearance & Shape:** To be free from any defect such as flow, burrs, unevenness etc, As per IEC standards.

**Effective Parameters irrespective of material grade (per piece)**

- Effective Length ( $L_e$ ): 76.0 mm
- Effective Area ( $A_e$ ): 93.8mm<sup>2</sup>
- Effective Area ( $A_{Min}$ ): 93.8mm<sup>2</sup>
- Effective Volume ( $V_e$ ): 7129mm<sup>3</sup>

**Approximate weight : 34.5g/pc**



## T3115 OL (Un- Coated)

**Test Conditions: 10kHz/150mV/CFR COIL,N=01/Lo=Zero/25°C**

Material Grade	Initial Permeability ( $\mu_{iac}$ )	AL Value (nH)	Ordering code
CF196	2000 $\pm$ 20%	3100+30%/-20%	CF196T3115
CF139	2100 $\pm$ 20%	3250+30%/-20%	CF139T3115
CF130	3000 $\pm$ 20%	4650+30%/-20%	CF130T3115
CF195A	5000 $\pm$ 20%	7700+30%/-20%	CF195AT3115
CF265	5000 $\pm$ 20%	7700+30%/-20%	CF265T3115
CF190	6000 $\pm$ 20%	9300+30%/-20%	CF190T3115
CF197	7000 $\pm$ 20%	10800+30%/-20%	CF197T3115
CF199	9000 $\pm$ 20%	14000 $\pm$ 30%	CF199T3115

## Dimensions(Un-coated Core)

Dimension	Nominal (in mm)	Maximum (in mm)	Minimum (in mm)
A	31.5	32.5	30.5
B	19.0	19.6	18.4
C	15.0	15.4	14.6

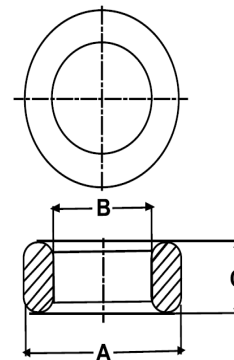

For general terms and conditions please visit: [http://www.cosmoferrites.com/Downloads/Downloads/bcb70e7c-ae33-40ec-a881-0d5120db57b6\\_GTC.pdf](http://www.cosmoferrites.com/Downloads/Downloads/bcb70e7c-ae33-40ec-a881-0d5120db57b6_GTC.pdf)