



Shenzhen ILENSTECH Optoelectronics Co.,Ltd

ADD:7F 3-B Building Tongtai Industrial Area Bao'an Road 6259 Bao'an District Shenzhen
Tel: 0086-755-23003651 Fax: 0086-755-23204131 Email: ilenstech@outlook.com

ILENS228-R5050-9090-12H1-NH

- Product Type: Street Light Lens
- Product Material: PC
- Product Certification: ROHS
- Size: 49.89*49.89*8.11mm
- LED: 2835、3030
- Beam Angle(FWHM): Asymmetric 90*90°
- Applicaion: Street lamp、Tunnel light



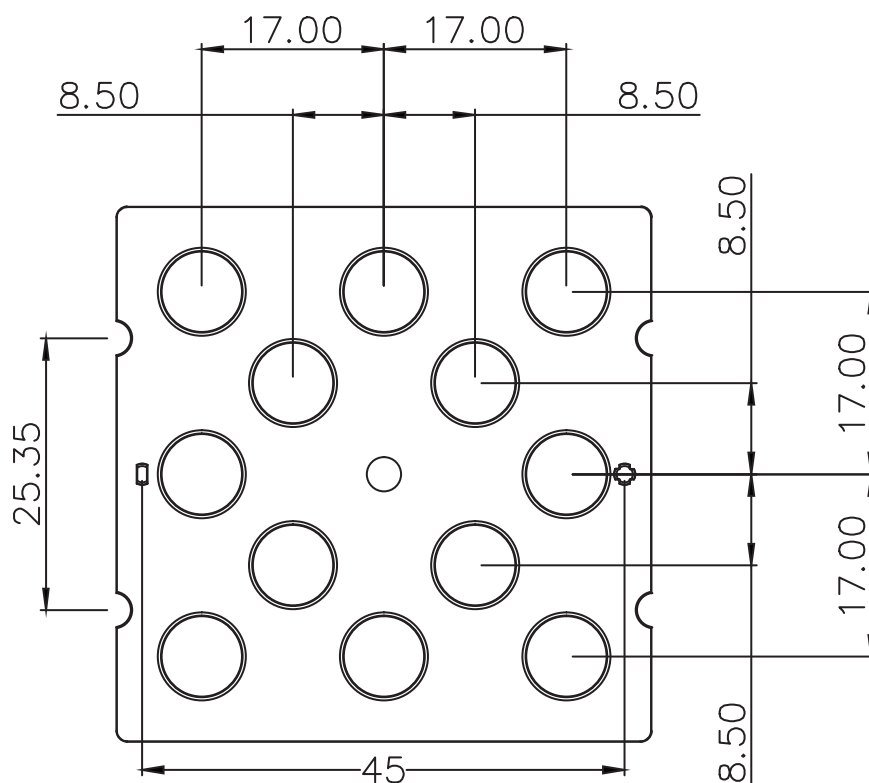
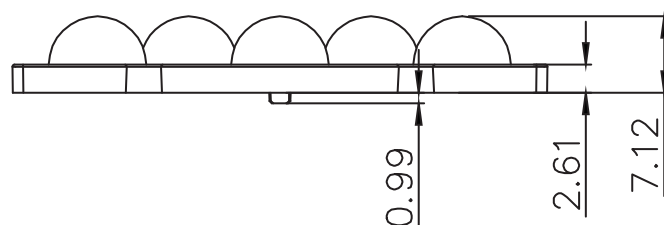
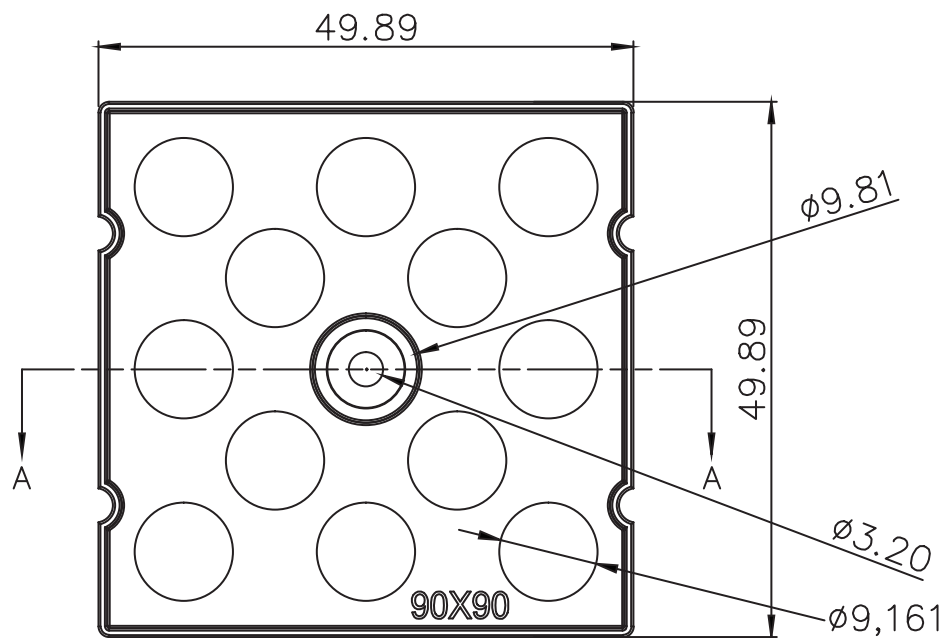

DRAWING TITLE

ILENS228-R5050-9090-12H1-NH

GENERAL TOLERANCES
(UNLESS STATED)

THIRD ANGLE
PROJECTION



This drawing is the property of ILENSTECH Optoelectronics Co.,Ltd. It may not be reproduced, copied or communicated without a written agreement with ILENSTECH Optoelectronics Co.,Ltd

LINEAR ANGULAR

MATERIAL

PC

COLOUR

Clear

SCALE

X ± 0.25 X $\pm 1^\circ$

UNIT

MM

X.X ± 0.20 X.X $\pm 0.5^\circ$

SIZE

A4

X.XX ± 0.10

SHEET

1/1

ILENSTECH

Shenzhen ILENSTECH Optoelectronics Co.,Ltd

Light distribution curve

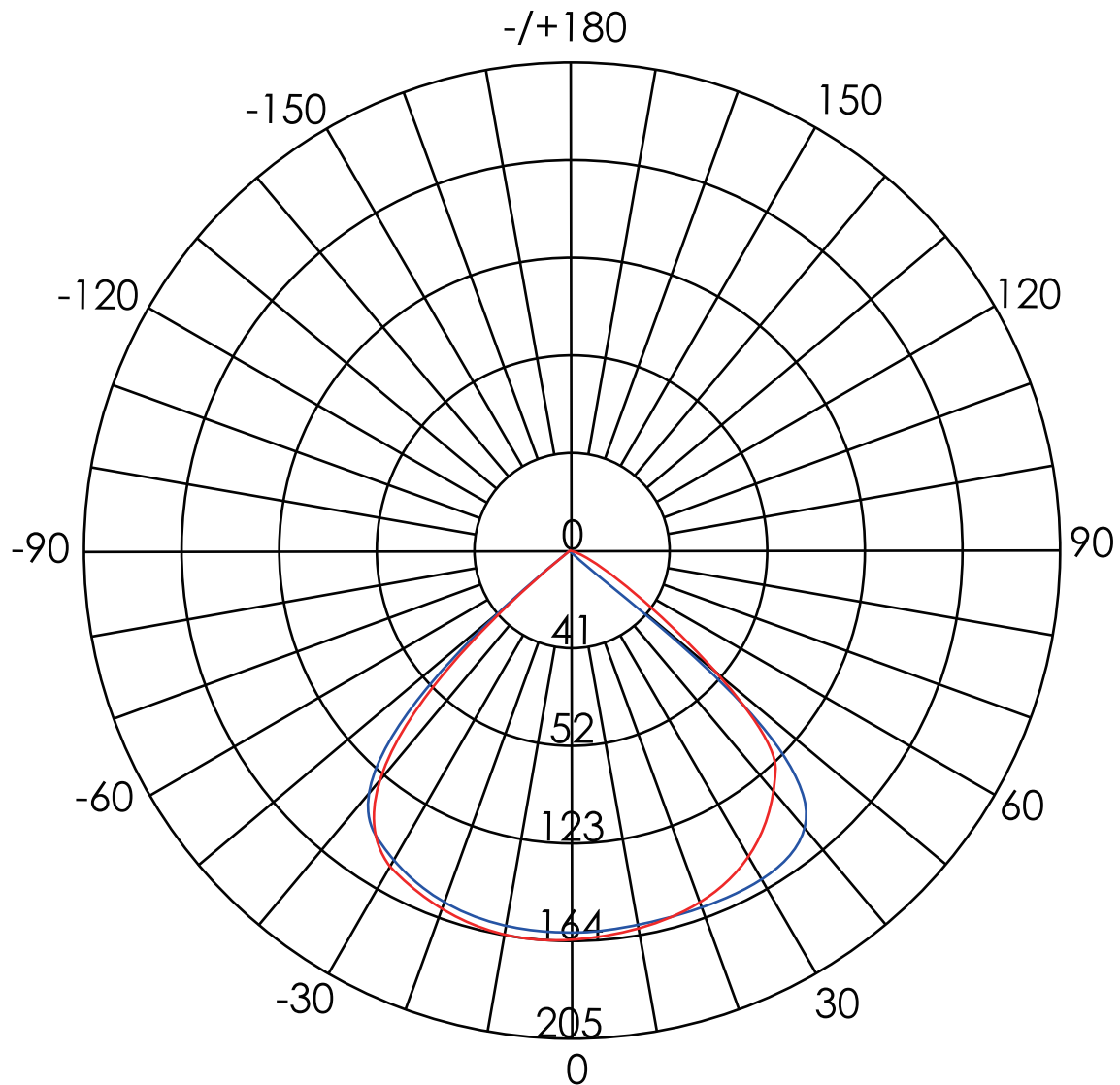

— CO-C180
— C90-C270
—

Unit : cd

Attention

- Storage: Do not store in dusty place, or expose under corrosive environment.
- Contact: Do not touch the lens surface with bare-hand. Please use gloves to touch the lenses.
- Cleaning: Clean lenses only if necessary. Use only mild soap, water and soft cloth. Do not use any commercial cleaning solvents
- The temperature of the lens in the working environment is controlled at $-40^{\circ}\text{C} \sim +80^{\circ}\text{C}$.
- Storage environment requirements, temperature: $0^{\circ}\text{C} \sim 40^{\circ}\text{C}$ humidity: 30%~95%.
- Before use the lens, don't open the package to avoid dust pollution.
- Avoid direct sunlight to avoid Aging, discoloration, fission and other adverse effects.
- Do not use acidic or alkaline solvents to touch the product to avoid chemical reactions.