

RoHS COMPLIANT

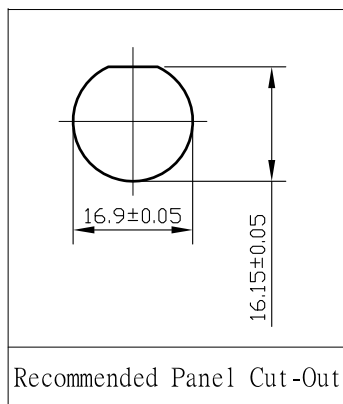
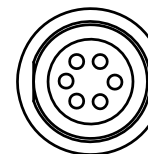
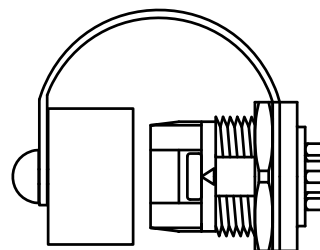
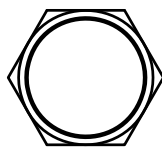
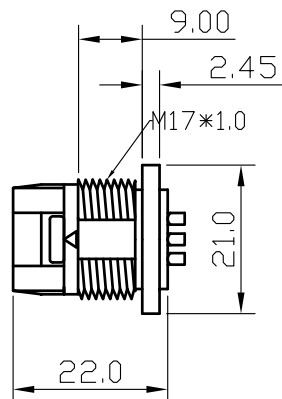
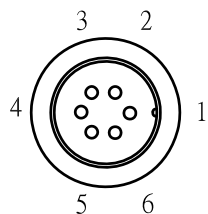

Recommended Panel Cut-Out

包裝方式: PCS/PE Bag; PCS/箱

7	ROPE	LJ-125-DCR-P(EP80/LDPE)	1	BLACK(O
6	DUST COVER	LJ-125-DC-R(EP70)	1	BLACK(O
5	NUT	LJ-125-M17PNAB	1	BLACK(O
4	EPOXY	5350 比例:A:B=4:1		BLACK(O
3	GASKEY	LJ-125-1521PG	1	BLACK(O
2	TERMINAL	LJ-910-XX	6	鍍金
1	HOUSING	LJ-125XXXPE-SM-NP	1	BLACK(O
NO	PART NAME	PART NO	Q'TY	COLOR

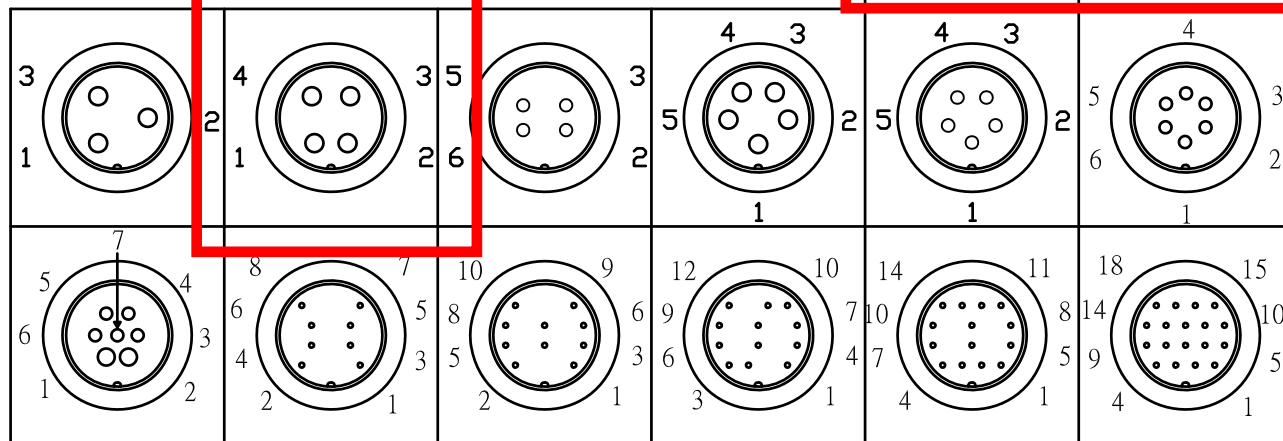

設計 DR. Marco 2018/08/20	核准 APPD.	容許公差 .XXX ±0.10 .XX ±0.25 .X ±0.38 X ±0.50 ANG ±3°	TOLERANCE	品名 ARTICLE LJ-125XXXPE-SM-NP+DC(編織繩)		
版本說明 REVISION NOTE --- Preliminary ---				圖號 DWG NO. L160606001		
			單位 UNIT	比例 SCALE	張數 SHEET	版本 REV.
			mm	1.5/1	1/1	A1