

REV.	DESCRIPTION	DRAWN	DATE
1	INITIAL RELEASE	FROS	2019/10/07

**SPECIFICATION:**

1. ELECTRICAL
  - 1.1 Current Rating: 1.5A per pin
  - 1.2 Voltage Rating: 30V AC/DC
  - 1.3 Contact Resistance: 30mΩ
  - 1.4 Insulation Resistance: 1000MΩ
  - 1.5 Dielectric Withstanding Voltage: 500VAC
2. MECHANICAL
  - 2.1 Durability: 1500 Cycle
  - 2.2 Insertion Force: 35N max.
  - 2.3 Extraction Force: 10N min.
3. ENVIRONMENTAL
  - 3.1 Operating temperature range: -55°C~+85°C
  - 3.2 Storage temperature range: -55°C~+85°C
4. SOLDER ABILITY
  - 4.1 Recommended IR Reflow Temperature: 260°C
  - 4.2 Recommended PCB Thickness: 1.0mm

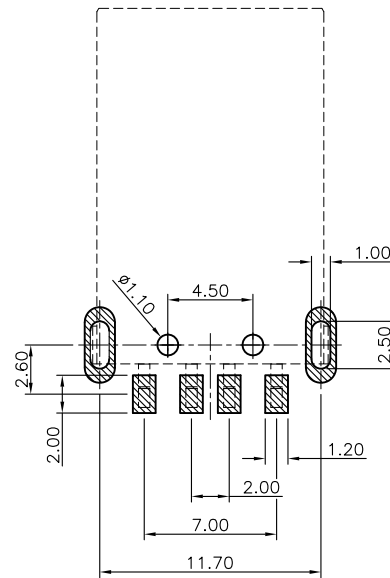
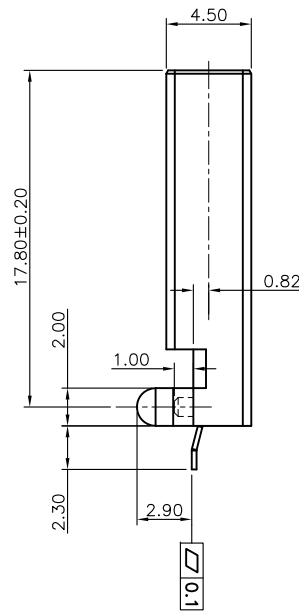
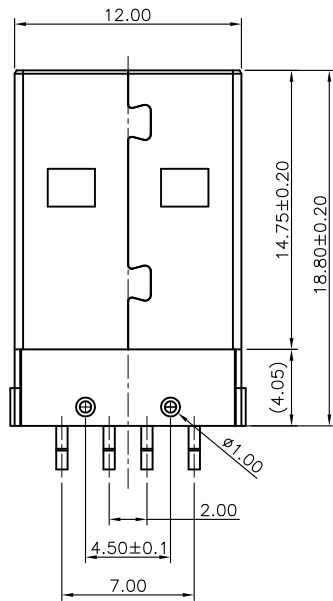
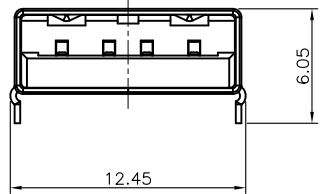

**RECOMMENDED LAYOUT (TOP VIEW)**  
**GENERAL TOLERANCE: ±0.05mm**

3	SHELL	SPCC, 80u" min. nickel, 40u" Cu under plating over all	
2	CONTACT	Brass 0.25t, 0.8u" min. gold plating on contact area, 80u" min. tin plating on solder tails, 40u" min. nickel under plating over all	
1	HOUSING	LCP, UL94V-0, Black	
NO. PART NAME		DESCRIPTION	
UNLESS OTHERWISE SPECIFIED TOLERANCE			
UNIT:	DECIMAL	LINEAR	ANGLES
mm	X.	±0.50	±5°
	X.X	±0.25	±3°
	X.XX	±0.12	±1°
DRAWN		Fros	2019/09/26
CHECKED		Tim	2019/09/26
APPROVED		Ken	2019/09/26
DRAWN NAME:		USB A Plug Middle Mount SMT Type	
PRODUCT NO.		205A-SA02	
SCALE		SHEET	SIZE
2.5		1/1	A4
FILE NAME		205A-SA02_B_1	



www.attend.com.tw