

SPECIFICATIONS
 Rated Current:1.5AMP
 Contact Resistance:20mΩ Max
 Withstand Voltage:500V AC/DC
 Insulation Resistance:1000MΩ Min
 Operation Temperature:-40°C to +105°C

Contact Material:Phosphor Bronze
 Contact Plating:Au or Sn Over Ni
 Insulator Material:Polyester(UL94V-0)
 Standard: PA6T
 Max.Processing Temp: 230°C for 30-60 seconds
 (260°C for 10 seconds)

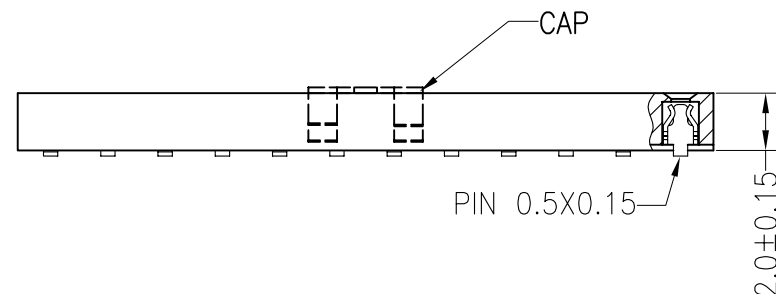

Recommended P.C.B Layout(Top Side)
 (PCB BOARD TOLERANCE±0.05)

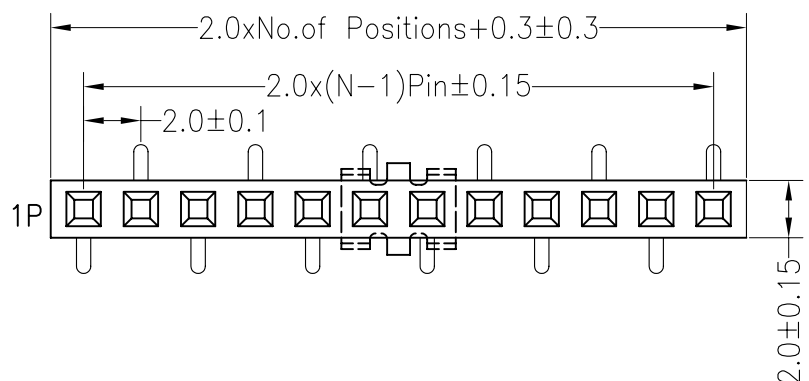
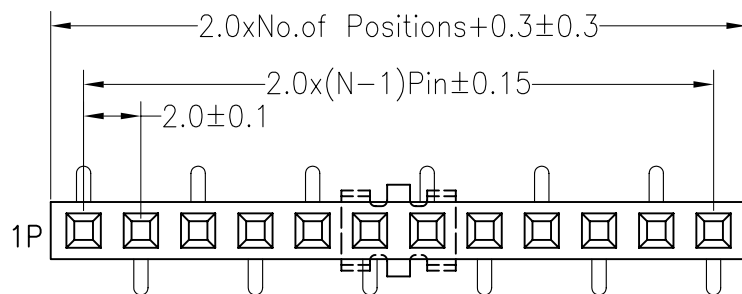
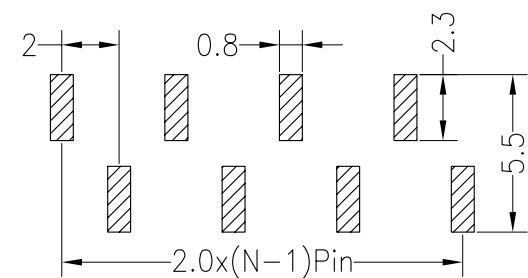

TYPE2

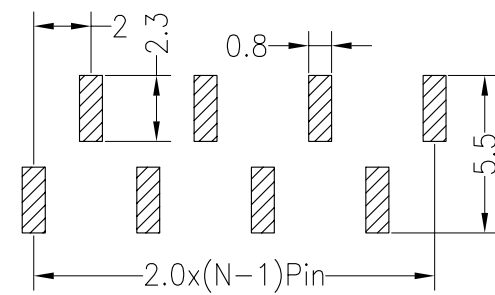

TYPE1

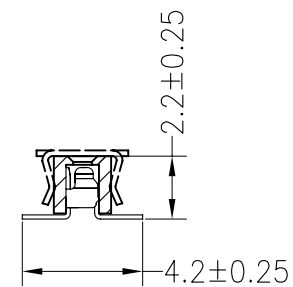

				OPERATION		DRAW	YiYuSheng	12.04.18	SCALE	FIT	NINGBO KLS ELECTRONIC CO.,LTD	
				X.X	±0.30				UNIT	mm		
				X.XX	±0.20	CHECK		SIZE	A4	PART NO.		
A0	2012.04.18	NEW DRAWING		X.XXX	±0.10					APPROVE		SHEET
REV	DATE	MODIFICATION DESCRIPTION		CHANGE	DIM	TOL		PROJ.	◆			