

Recommended P.C.B Layout(Top Side)  
(PCB BOARD TOLERANCE±0.05)

**SPECIFICATIONS**  
 Rated Current:3.0AMP  
 Contact Resistance:20mΩ Max  
 Withstand Voltage:1000V AC/DC  
 Insulation Resistance:1000MΩ Min  
 Operation Temperature:-40°C to +105°C

Contact Material:Brass  
 Contact Plating:Au Over Ni  
 Insulator Material:Polyester(UL94V-0)  
 Standard: PA6T  
 Max.Processing Temp: 230°C for 30-60 seconds  
 (260°C for 10 seconds)

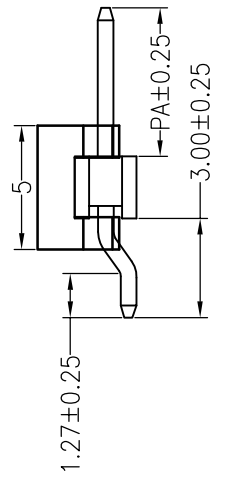
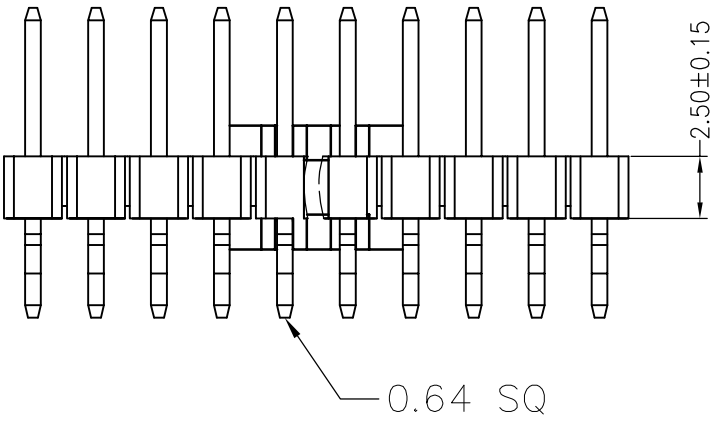
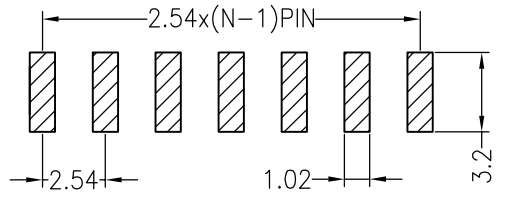
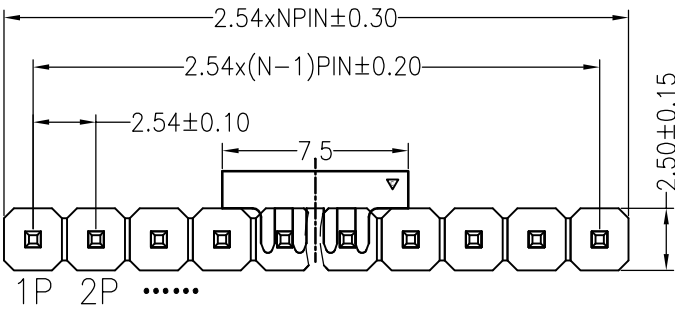

Dimension antitheses list		
ITEM	PA	L
Standard	6.00	11.70

					OPERATION	DRAW	YiYuSheng	12.03.28	SCALE	FIT	<b>NINGBO KLS ELECTRONIC CO.,LTD.</b>
					X.X	±0.30			UNIT	mm	
					X.XX	±0.20			SIZE	A4	
					X.XXX	±0.10			SHEET	1/1	
					Angle	±3°			PROJ.		
A0	2012.03.28	NEW DRAWING			DIM	TOL	APPROVE		PART NO.	L-KLS1-207A-1-08-TC-3.0*6.0*11.7-R	
REV	DATE	MODIFICATION DESCRIPTION	CHANGE						TITLE:	2.54PH H2.5mm Dual Row 卧贴 夹持盖	