

PCB Relay**TRCD/TRCDF**

- Sub-miniature dimensions: $23 \times 16.1 \times 10.2$ (L×W×H)
- High-sensitivity models available with low power consumption (200 mW)
- Conform to ROHS,ELV directive

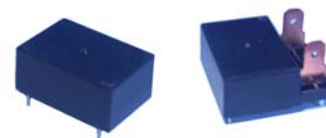

$23 \times 16.1 \times 10.2$
 $25 \times 23 \times 10.2$



06001015775



E173485



R50066938

ORDERING CODE

TRCD L — 12VDC — S — H
 1 2 3 4 5

- | | |
|--|------------------------------|
| 1. Relay Model | 4. Sealed |
| 2. Coil Power
L=0.2W, D=0.36W, N=0.45W | 5. Contact Form
H: Form A |
| 3. Coil Nominal Voltage
3,5,6,9,12,24,48VDC | |

COIL DATA

Nominal Voltage(VDC)	3	5	6	9	12	24	48	0.45W
Coil Resistance($\Omega \pm 10\%$) at 20°C	20	56	80	180	320	1280	5120	
Rated Current(mA)	150	90	75	50	37.5	18.7	9.4	
Max Operate Voltage(VDC)	2.25	3.75	4.5	6.75	9	18	36	
Min Release Voltage(VDC)	0.15	0.25	0.3	0.45	0.6	1.2	2.4	0.2W
Coil Resistance($\Omega \pm 10\%$) at 20°C	45	125	180	405	720	2880		
Rated Current(mA)	66.7	40	33.3	22.2	16.7	8.3		
Max Operate Voltage(VDC)	2.25	3.75	4.5	6.75	9	18		
Min Release Voltage(VDC)	0.15	0.25	0.3	0.45	0.6	1.2		0.36W
Coil Resistance($\Omega \pm 10\%$) at 20°C	25	69	100	225	400	1600	6400	
Rated Current(mA)	120	72	60	40	30	15	7.5	
Max Operate Voltage(VDC)	2.25	3.75	4.5	6.75	9	18	36	
Min Release Voltage(VDC)	0.15	0.25	0.3	0.45	0.6	1.2	2.4	
Max Applicable Voltage	130% at 70°C, 170% at 23°C							

CONTACT DATA

Contact Form	1H
Contact Material	Silver Alloy
Load	Resistive load(COS Φ =1)
Contact Ratings	16A 250VAC 10A 250VAC/24VDC 15A 125VAC 1/2HP 125VAC TV-5A @125VAC(LAMP)
Minimum load	100mA 5VDC
Max Switching Voltage	250VAC/125VDC
Max Switching Current	16A

Max Switching Power	4000VA/480W
Contact Resistance	100mΩ Max at 6VDC 1A
Life Expectancy	Electrical: 100,000 Operations(at30Operations/minute)
	Mechanical: 10,000,000 Operations

■ GENERAL DATA

Insulation Resistance	100MΩ Min at 500VDC
Dielectric Strength Between Open Contacts	750VAC(for one minute)
Between Contacts and coil	2500VAC(for one minute)
Operate Time	15ms
Release Time	8ms
Temperature Range	-40°C to +85°C
Shock Resistance	Operating Extremes: 10G
	Damage Limits: 100G
Vibration Resistance	10-55Hz, 1.5mm
Max. switching frequency	Mechanical: 18,000operations/hr
	Electrical: 1,800operations/hr
Humidity	20-85%
Weight	Approx 10g
Safety Standard	UL、TÜV、CQC

■ APPROVED STANDARDS

Model	Coiling rating	Safety Standard	Contact rating
TRCD(TRCDF)	3 to 48VDC	TÜV	16A 250VAC 10A 250VAC 10A 24VDC
		UL/cUL	10A 250VAC 15A 125VAC 1/2HP 125VAC TV-5A @125VAC (LAMP)
		CQC	16A 250VAC

■ ENGINEERING DATA

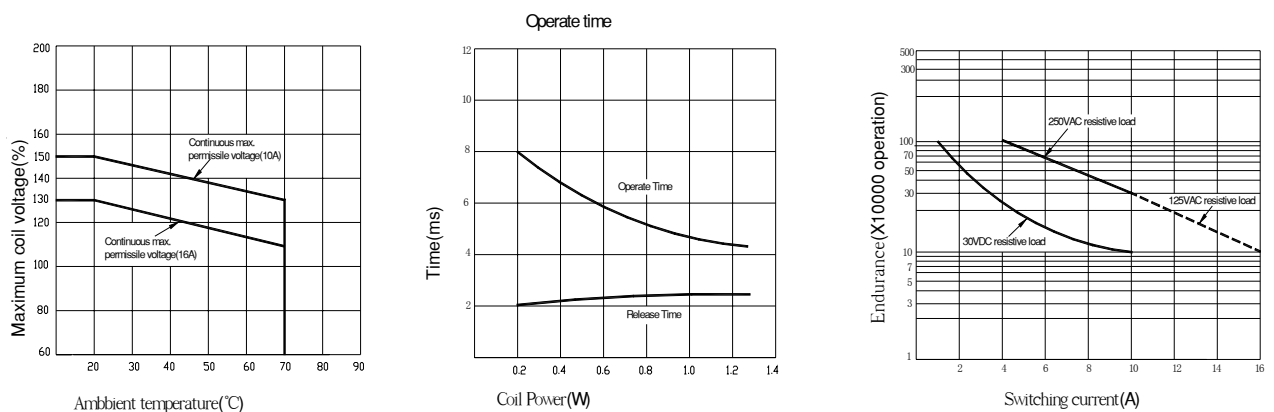

OVERALL AND MOUNTING DIMENSIONS

Outline dimensions

TRCD

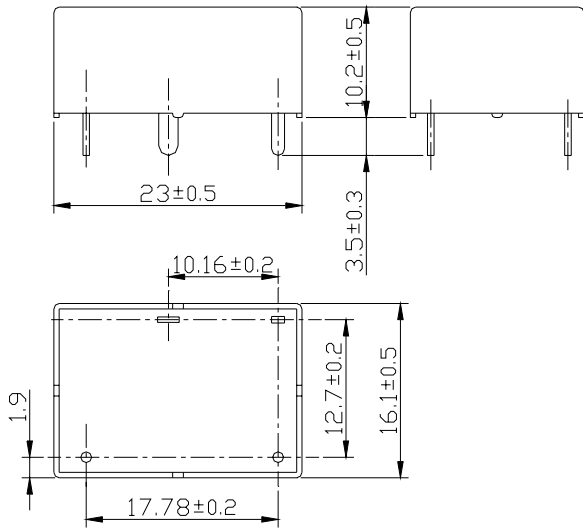

TRCDF

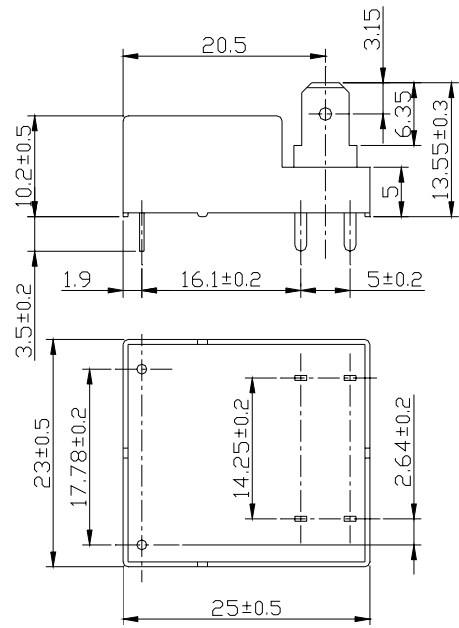

Wiring Diagrams

TRCD

TRCDF

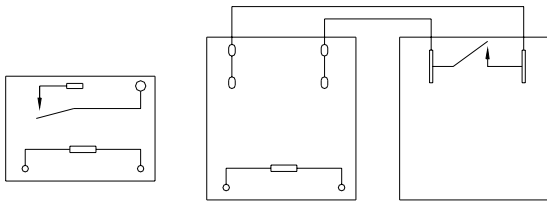

(Bottom View)

(Top View)

(Bottom View)

PC Board Layouts (Bottom View)

TRCD

TRCDF

