

REVISION RECORD			
REV	ECN	DESCRIPTION	DRFT DATE

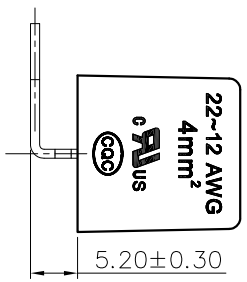
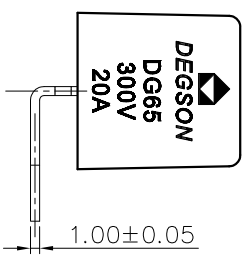
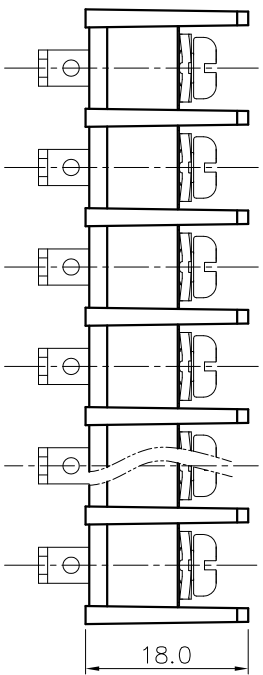
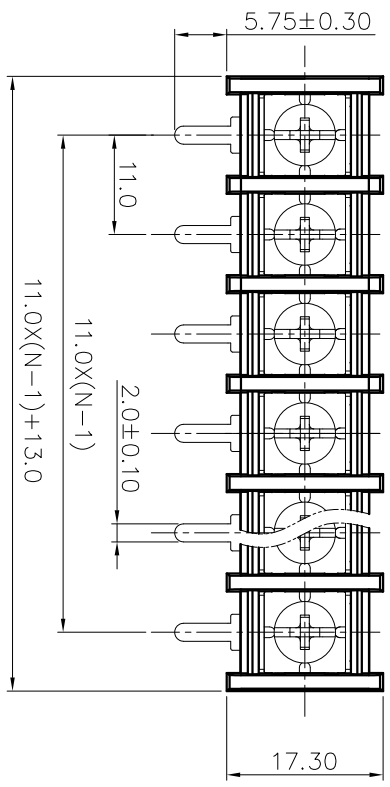

- NOTES1:
UL Standard
1. Rated voltage/current : 300V / 20A
2. Torque value : M4 , 10.53lb.in
3. Wire range : 22~12AWG

- NOTES2:
1. Dimension shall be interpreted per ASME Y14.5-2009
2. Pitch : 11.0mm, Poles = N=02~22P
3. Withstanding voltage : AC1600V/1Min
4. Operating temperature: -40°C~+105°C
5. Undimensioned tolerances:

Pitch range	In mm		Nominal dimension range		mm
	Over	TO	Over	TO	
6	10	24	30	60	0.1/0
10	24	30	60	100	0.1/0
15	30	60	100	150	0.1/0
20	60	100	150	150	0.1/0
25	100	150	150	150	0.1/0
30	150	150	150	150	0.1/0
40	150	150	150	150	0.1/0
50	150	150	150	150	0.1/0
60	150	150	150	150	0.1/0
70	150	150	150	150	0.1/0
100	150	150	150	150	0.1/0
150	150	150	150	150	0.1/0
200	150	150	150	150	0.1/0
250	150	150	150	150	0.1/0
300	150	150	150	150	0.1/0
400	150	150	150	150	0.1/0
500	150	150	150	150	0.1/0
600	150	150	150	150	0.1/0
700	150	150	150	150	0.1/0
800	150	150	150	150	0.1/0
900	150	150	150	150	0.1/0
1000	150	150	150	150	0.1/0

6. RoHS Compliance

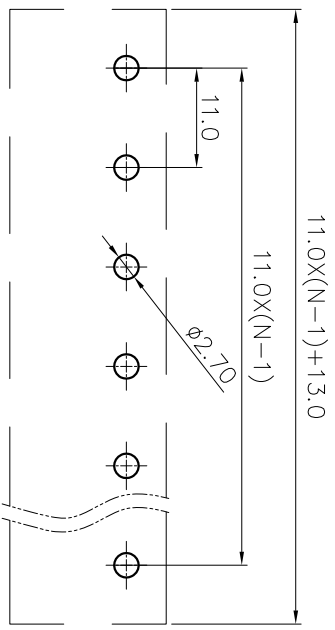
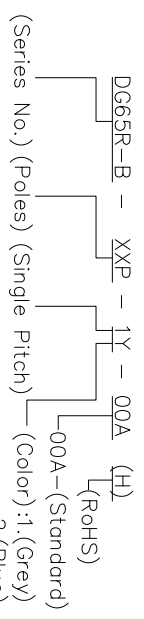

PCB LAYOUT

DETACHED LISTS			
PART NO.:	/	NAME:	DEGSON® NINGBO DEGSON ELECTRICAL CO., LTD 宁波高松电子有限公司
APPD:	/	TITLE:	CUSTOMER DRAWING
CHKD:	/	DRAWING NO.:	/
DRFT:	/	REV	DO
THIRD ANGLE PROJECTION		SHEET	1/1
		SCALE	1:1

A 8 7 6 5 4 3 2 1