

1 2 3 4 5 6 7 8 9

G

**Materials**  
 Pin:Brass,machined, (H59-3)  
 Plating:Gold plated:1.25u"m/50u"nickel,full gold  
 Insulator body(black):PPS( UL94V-0)

F

**Electrical**  
 Current rating:3 Amps/contact max.  
 Contact resistance:20mΩ  
 Insulation resistance:1000MΩ  
 Operating voltage:60 AC/DC

E

**Mechanical**  
 Operating temperature :Gold plated:-55°C to +105°C  
 (Continuous) -67"H to +105"H  
 Tin plated:-40°C to +105°C  
 Soldering temperature:260°C,10s max

D

C

B

A

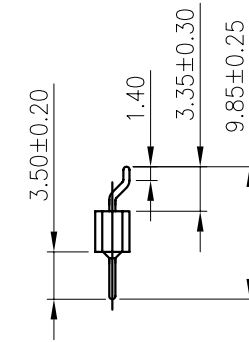
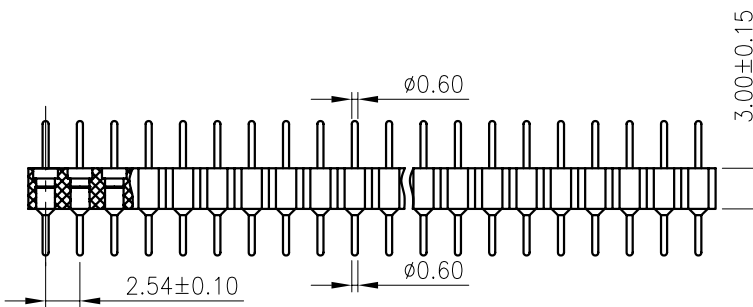
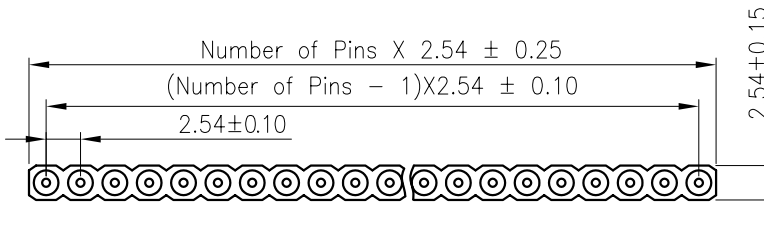

G

F

E

D

C

B

A

					OPERATION		DRAW	WZG	14.04.01	SCALE	FIT	<b>KLS ELECTRONIC CO., LTD</b>		
					X.X	±0.30				UNIT	mm			
					X.XX	±0.20	CHECK	SIZE	A4	PART NO.	L-KLS1-209XA-3.0-1-XX-RM			
					X.XXX	±0.10	APPROVE	SHEET	1/1	TITLE:	2.54X3.0 双头针 L=10.0 针尖0.60卧贴			
REV	DATE	MODIFICATION DESCRIPTION		CHANGE	DIM	TOL				PROJ.				

1 2 3 4 5 6 7 8 9