

编号	修改原因	制图	审核	批准
A		张萍萍 2009.04.03		

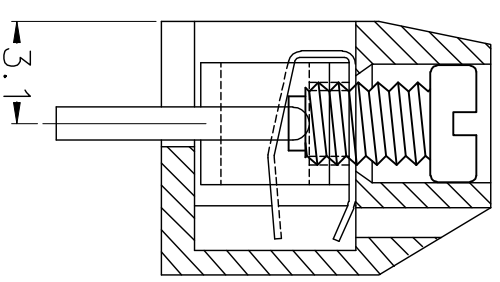
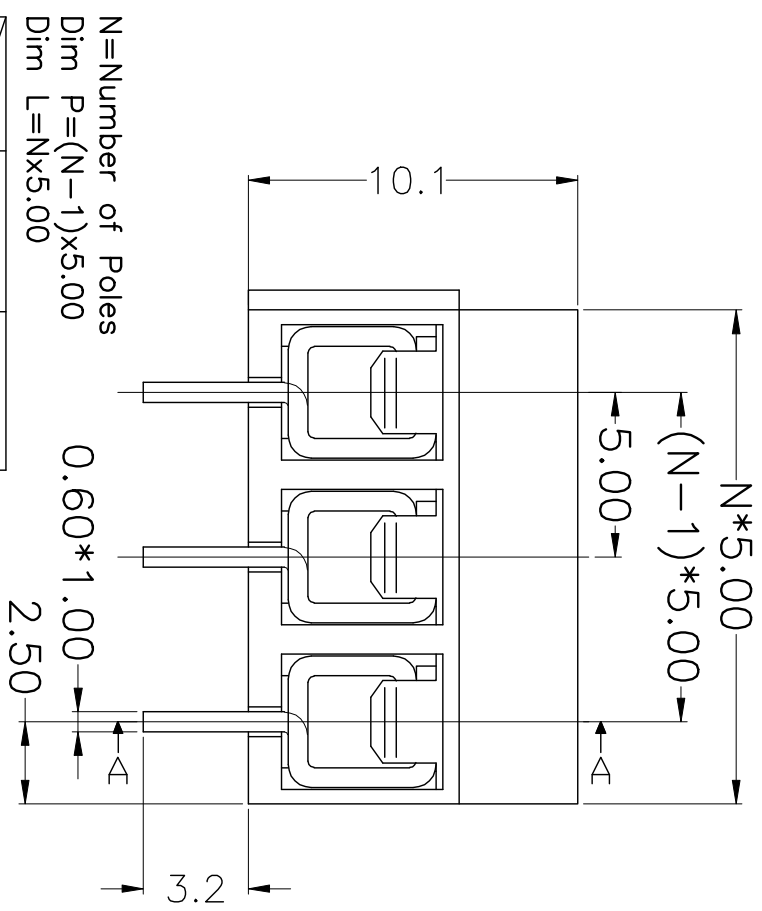
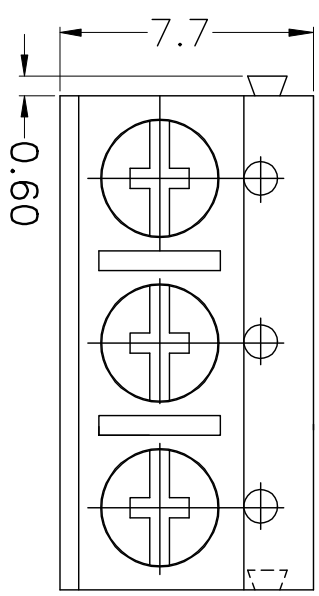

• **Material**
 Screws: M2.5 Steel Zinc plated
 Wire guard: Phosphor bronze,
 Ni plated or stainless steel
 Pin header: Brass, Tin plated
 Housing: PBT, UL94V-0

• **Electrical**
 Rated voltage : 300V
 Rated current : 12A
 Contact resistance : 20mΩ
 Insulation resistance : 5000MΩ/1000V
 Withstanding voltage : AC2000V/1Min
 Wire range : 22-14AWG 2.5mm²

• **Mechanical**
 Temp. Range : -30℃~+120℃
 MAX Soldering : +250℃, for 5 sec.
 Torque: 0.4Nm (3.54lb.in)
 Strip length : 4.5-5mm

Dim	Dim P	Dim L
Poles		
2-6P	±0.10	±0.15
7-12P	±0.20	±0.20
13-18P	±0.25	±0.30
19-24P	±0.30	±0.40

N=Number of Poles
 Dim P=(N-1)x5.00
 Dim L=Nx5.00

尺寸公差:
 X, ±0.20
 .X ±0.15
 .XX ±0.10

角度公差:
 X, ±2°
 .X ±1°
 .XX ±0.5°

绘图类型: AUTO CAD
 比例: 1:1
 图框: 1\1
 图纸编号: KF302-XP6LV

投影法: 第一角投影
 单位: mm
 纸张尺寸: A4
 品名: KF302-5.00
 产品系列: KF302 系列

KF
 KAIFENG ELECTRONIC
 慈溪市凯峰电子有限公司
 KAIFENG ELECTRONIC CO.,LTD