



MMCX7-J-P-GF-RA-TH1



MMCX7-J-P-HF-ST-TH1



MMCX7-P-P-HF-ST-TH1

MMCX7 SERIES

75Ω MICRO-MINI SYSTEMS

SPECIFICATIONS

For complete specifications and recommended PCB layouts see www.samtec.com?MMCX7-TH

Housing Material:

ABS

Shell Material:

Brass

Insulator Material:

PTFE

Contact Material:

BeCu

Pin Material:

Brass

Operating Temp Range:

-65°C to +125°C

Insulation Resistance:

600 MΩ min

Contact Resistance:

Center: Testing Now!

Outer: 25 mΩ

Impedance:

75Ω

Dielectric Withstanding Voltage:

500 Vrms, 50 Hz

Dielectric Working Voltage:

170 Vrms, 50 Hz

Frequency Range:

0-6 GHz

RoHS Compliant:

Yes

Processing:

Lead-Free Solderable:

Yes

MMCX7

GENDER

TYPE

PLATING

ORIENTATION

TERMINATION

Mates with:
MMCX7-P, RF179,
GRF7H-C

-J
= Jack

-P
= PCB Mount

-HF
= 30μ" (0,76 μm) Gold center contact,
3μ" (0,08 μm) Gold outer contact

-RA
= Right Angle

-ST
= Straight

-TH1
= Through-hole

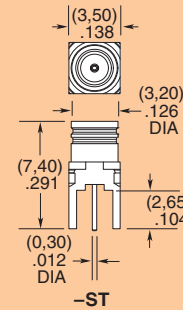
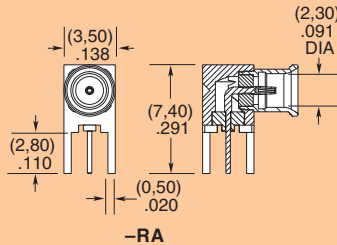

MMCX7

GENDER

TYPE

PLATING

ST

TH1

Mates with:
MMCX7-J, RF179,
GRF7H-C

-P
= Plug

-P
= PCB Mount

-HF
= 30μ" (0,76 μm) Gold center contact,
3μ" (0,08 μm) Gold outer contact

-GF
= 10μ" (0,25 μm) Gold center contact,
3μ" (0,08 μm) Gold outer contact

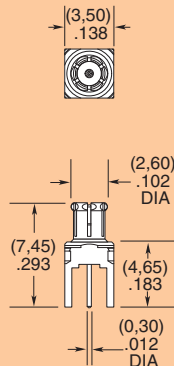

Due to technical progress, all designs, specifications and components are subject to change without notice.

WWW.SAMTEC.COM