

AHI-JS-DR-01-042

MARK	ECN	DESCRIPTION	DWN.	DATE

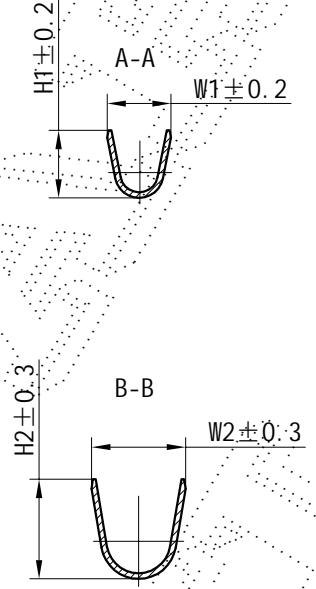
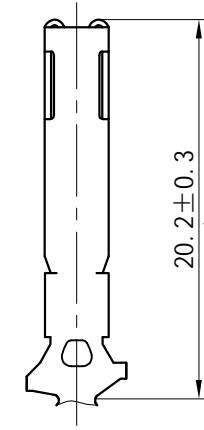
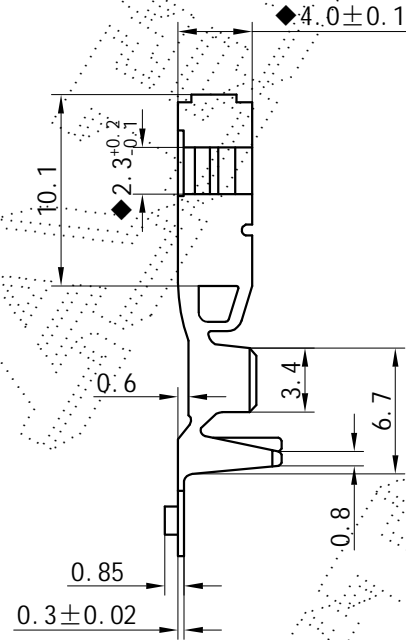
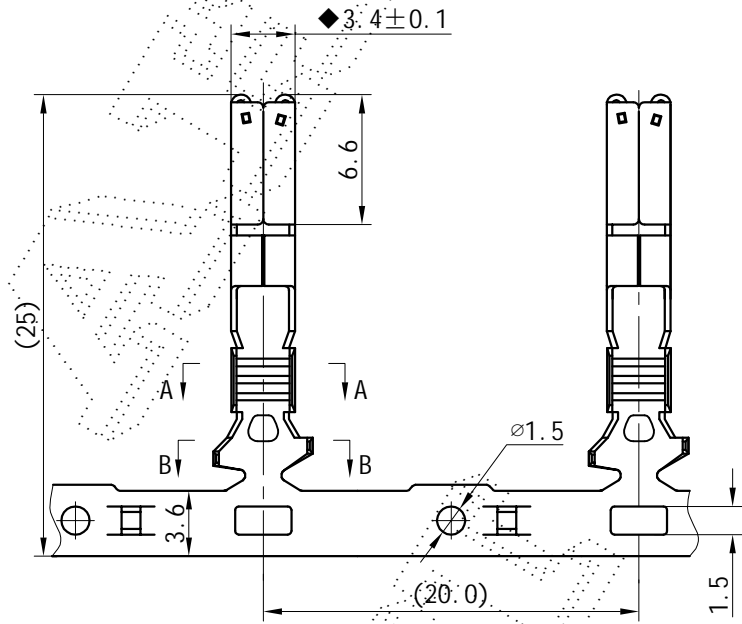

The technical requirements:
 1. pieces of the surface are not allowed to have obvious scratches, cracks, deformation
 Stamping defects, chamfer is clear, stamping Feng is less than 0.02mm
 2 not note round R R0.2 to R0.5mm
 3 product beading and stiffener depth 0.08-0.1mm
 4 "◆" is the important characteristic, "★" As the key characteristics.
 5 did not note the size tolerance in table GB/T15055-2007-m.

NO. TOLERANCES GB/T15055-2007-m	
DIM. RANGE	DIM. TOLERANCES
0.5~3	±0.20
>3~6	±0.30
>6~30	±0.40
>30~120	±0.50

NO.	PART NO.	W1	W2	H1	H2	Wire Range(mm ²)
②	DJ627-B2.8×0.8B	3.4	5.2	3.6	5.2	1.0-1.5
①	DJ627-B2.8×0.8A	2.8	4.6	2.2	4.1	0.5-0.85

SURFACE TREATMENT	TIN-PLATED	AHI 乐清市奥海电气有限公司 Yueqing Aohai Electric Co., Ltd.				
MATERIAL	COPPER t0.3					
NAME	TERMINAL	DRAWN BY	CONFIRMED BY	APPROVED BY		
PART NO.	SEE TABLE					
TYPE						
ARTICLE NO.		REV.	1st-PERSON-VIEW	FREE	UNIT	PAGE
MOULD NO.:		1.0	2.5:1	mm	1/1	