



## SDC4D22HP SERIES~ SMD Shielded Power Inductors



### PART NUMBERING SYSTEM

<b>SDC</b>	<b>4D22HP</b>	—	<b>4R7N</b>	—	<b>LF</b>
TYPE	DIMENSIONS		INDUCTANCE		LEAD FREE

### SHAPES AND DIMENSIONS

UNIT : mm

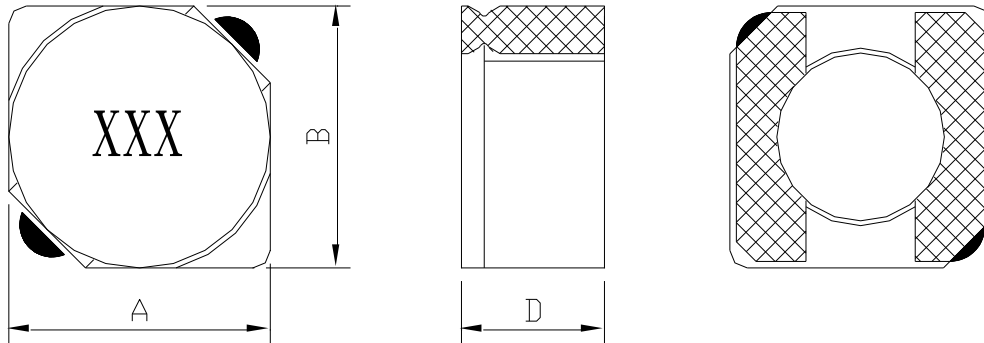

**A=5.0 Max. B=5.0 Max. D=2.4 Max.**

### PCB LAYOUT

UNIT : mm

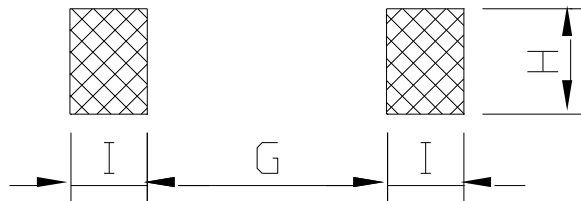

**G=1.5 Max. H=5.3 Max. I=1.9 Max.**

### FEATURES

- Only **5 mm square** and **2.4 mm high**
- **Magnetically shielded**
- Saturation current rating **up to 4.2 Amps**
- Inductance ratings from 1.2 to 100  $\mu$ H
- **RoHS-compliant.** 260°C compatible. Matte tin over nickel over phos bronze terminations

## SDC4D22HP SERIES~ SMD Shielded Power Inductors



### SPECIFICATION TABLE

PART NUMBER	INDUCTANCE ( $\mu$ H)	DCR ( $\Omega$ ) (Max.)	Isat (A)	Irms	(A)
SDC4D22HP-1R2N-LF	1.2 $\pm$ 30%	26.5m	4.20	3.20	
SDC4D22HP-1R5N-LF	1.5 $\pm$ 30%	31.3m	3.90	3.00	
SDC4D22HP-2R2N-LF	2.2 $\pm$ 30%	44.3m	3.20	2.40	
SDC4D22HP-2R7N-LF	2.7 $\pm$ 30%	57.8m	2.80	2.20	
SDC4D22HP-3R5N-LF	3.5 $\pm$ 30%	65.1m	2.50	2.00	
SDC4D22HP-4R7N-LF	4.7 $\pm$ 30%	82.6m	2.20	1.80	
SDC4D22HP-5R2N-LF	5.2 $\pm$ 30%	92.8m	2.00	1.70	
SDC4D22HP-6R3N-LF	6.3 $\pm$ 30%	0.110	1.85	1.40	
SDC4D22HP-8R2N-LF	8.2 $\pm$ 30%	0.128	1.65	1.35	
SDC4D22HP-100N-LF	10 $\pm$ 30%	0.144	1.50	1.30	
SDC4D22HP-120N-LF	12 $\pm$ 30%	0.187	1.30	1.10	
SDC4D22HP-150N-LF	15 $\pm$ 30%	0.213	1.20	0.85	
SDC4D22HP-180N-LF	18 $\pm$ 30%	0.239	1.10	0.80	
SDC4D22HP-220N-LF	22 $\pm$ 30%	0.267	1.05	0.90	
SDC4D22HP-270N-LF	27 $\pm$ 30%	0.394	0.90	0.70	
SDC4D22HP-330N-LF	33 $\pm$ 30%	0.449	0.80	0.65	
SDC4D22HP-390N-LF	39 $\pm$ 30%	0.668	0.75	0.52	
SDC4D22HP-470N-LF	47 $\pm$ 30%	0.723	0.70	0.50	
SDC4D22HP-560N-LF	56 $\pm$ 30%	0.810	0.65	0.48	
SDC4D22HP-680N-LF	68 $\pm$ 30%	0.923	0.60	0.45	
SDC4D22HP-820N-LF	82 $\pm$ 30%	1.220	0.55	0.40	
SDC4D22HP-101N-LF	100 $\pm$ 30%	1.370	0.48	0.35	

- Test frequenc at 100KHz / 0.1Vrms.
- Isat : DC current at which the inductance drops 35% (typ) from its value without current.
- Irms: The actual current when temperature of coil becomes  $\Delta 40^{\circ}\text{C}$ . (  $T_a = +25^{\circ}\text{C}$  )
- Operating temperature range  $-40^{\circ}\text{C}$  to  $+125^{\circ}\text{C}$  , Electrical specifications at  $25^{\circ}\text{C}$ .



## SDC4D22HP SERIES~ SMD Shielded Power Inductors



### PACKAGING SPECIFICATION

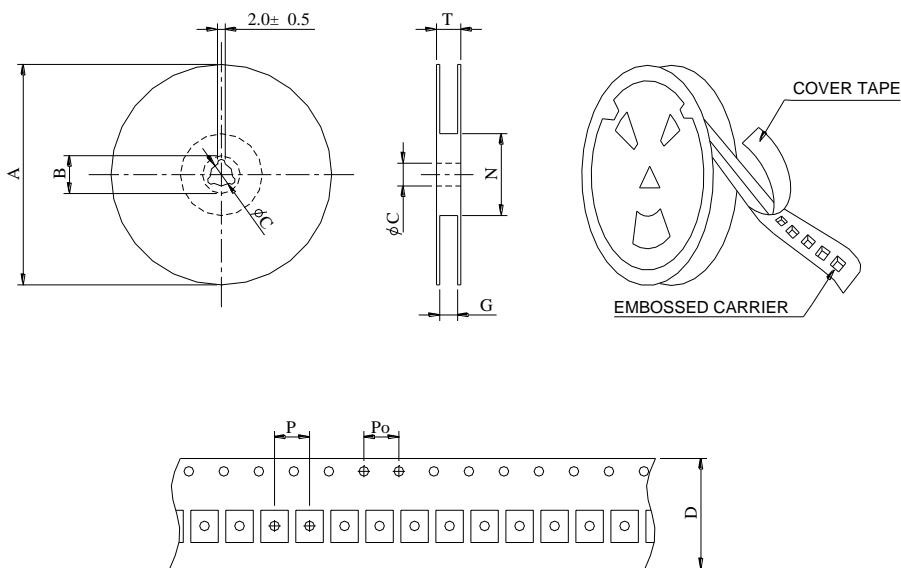

SERIES	STAYLE	Q'TY (PCS)	DIMENSIONS (m/m)								
			A	B±0.8	C±0.5	D	G <sup>+0</sup>	N <sup>0</sup>	P	Po	T
SDC4D22HP	13-16	2000	330	21	13	16	18	50	8	4	22.4