



# 承認書

## SPECIFICATION FOR APPROVAL

客戶(Customer): \_\_\_\_\_  
客戶料號(Customer P/N): \_\_\_\_\_  
機種編號(Files No.): \_\_\_\_\_  
機種型號(Model No.): RB-30008F-33R  
品名(Description): SPEAKER(RoHS)  
規格(Specification): 8Ω 1.0W

客戶承認欄 (Customer Authorization Signature)	供應商 (Supplier Audit)		
	Approver	Checker	Author
			程海英
日期: 2012 年 10 月 19 日			

### Revision History

Version	Date	Description	Author
A0	October 19.2012		程海英

东莞市瑞波电子有限公司

DONGGUAN RUIBO ELECTRONIC CO., L.T.D.

中國 廣東省 东莞市 企石镇 东山管理区 永盛工业园

Dong Shan Guan Li Qu, Qi Shi Town, Dong Guan City, Guang Dong, China

TEL: +86(0)769-8657 2629 FAX: +86(0)769-8657 2621

<http://www.ruibocn.com>



# DONGGUAN RUIBO ELECTRONIC CO., L.T.D.

## 东莞市瑞波电子有限公司

Dong Shan Guan Li Qu, Qishi Town, Dong guan City, Guangdong CHINA.

中國 廣東省 东莞市 企石镇 东山镇 永盛工业园

TEL: (86-769) 86572629 FAX: (86-769) 86572621

# SPECIFICATION

Above Measuring condition under temperature : 25~35°C R.H. 25 ~75%. According to standard GB/T9396-1996

	Model	RB-30008F-33R		
1	Type	Dynamic Speaker		
2	Dimension	Outline Dimension Shall Be As Shown In Fig(1).		
3	Weight	Approx 7.5 Grams.		
4	Magnet	Material	Nd-Fe-B	
5	Impedance	8 ± 15% Ohm at 1000Hz. 1V		
6	Power Rating	Normal	1.0W	Maximum 1.5W
7	FO	600Hz±150 at1.0V		
8	S.P.L.	96±3dB/1.0Watt 0.1Meter. Average At1000,1200,1500,2000 Hz.		
		Measurement Method Shown In Fig(2).		
9	Frequency Range	F0~20,000Hz.Average SPL-10dB. Frequency Response Fig (3).		
10	Distortion	10% Maximum At 1000Hz. 1.0W.		
11	Abnormal Sound Test	Must be Normal Tested by 2.83 Volts. Sine wave for50~5kHz		
12	Polarity	Diaphragm Shall Move Forward When Apply a Positive DC.		
		Red "+" or "Marked" Terminal		
13	Operating Temperature	-25°C to +65°C		
14	Storage Temperature	-25 °C to +65 °C		

15	Reliable Test	After any following test leave speakers at room temperature for 1 hour, SPL shall not deviate by±3 db from initial value		
15-1	Load Test	white noise for 96 hours at 1.0 W input power.		
15-2	High Temperature Test	+65±2 °C 96hours		
15-3	Low Temperature Test	-25±2 °C 96hours		
15-4	Humidity Test	+40±2 °C relative humidity 90~95%R.H 96hours		
15-5	Vibration Test	Frequency 30± 15 Hz, Amplitude 1.5 mm for 2 Hours per axis(x. y. z axis)		
15-6	Drop Test	75 CM free falling on Concrete floor, 10 times.		
15-7	Temperature Cycle test	-25~ + 65 °C 5 Cycles Temperature test.		

DATE	SPEC.NO	Version	Page
October 19.2012	SCM0284	A0	2/5

# SPECIFICATION

Model : RB-30008F-33R

16: Drawing(Fig1) Unit: mm Tolerance:±0.3mm

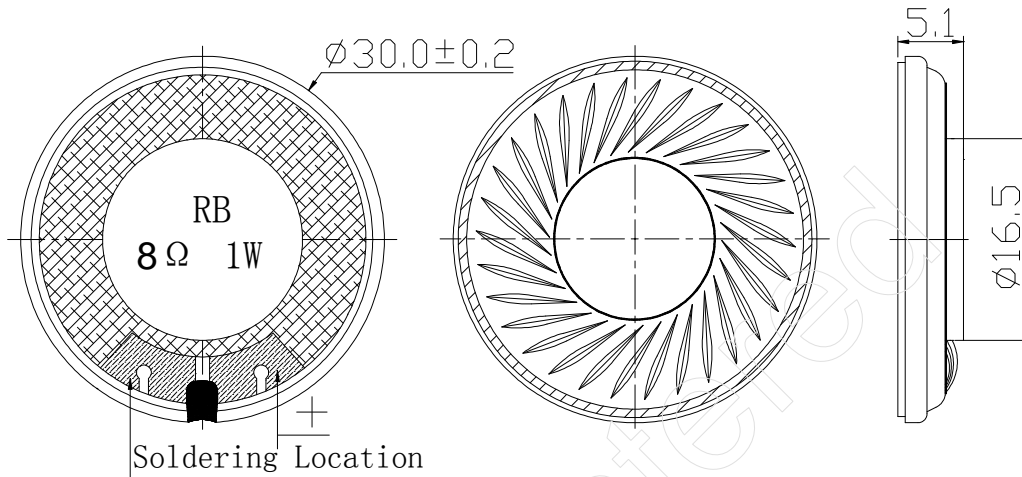

17. Speaker Construction

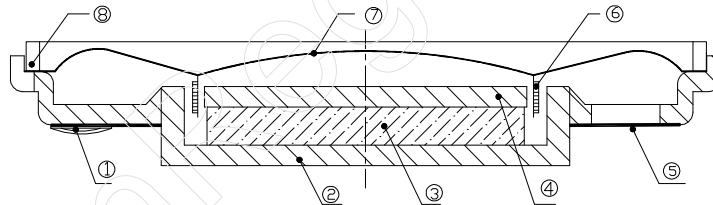

NO	PART NAME	MATERIAL	Q'TY
1	TERMINAL	P.C.B	1
2	FRAME	SPCC	1
3	MAGNET	Nd-Fe-B	1
4	WASHER	SPCC	1
5	CLOTH	CLOTH	1
6	VOICE COIL	DIA 13.28	1
7	DIAPHRAGM	MYLAR	1
8	GASKET	ABS	1

DATE	SPEC.NO	Version	Page
October 19.2012	SCM0284	A0	3/5

# SPECIFICATION

### 18.Measurement Method Fig(2).

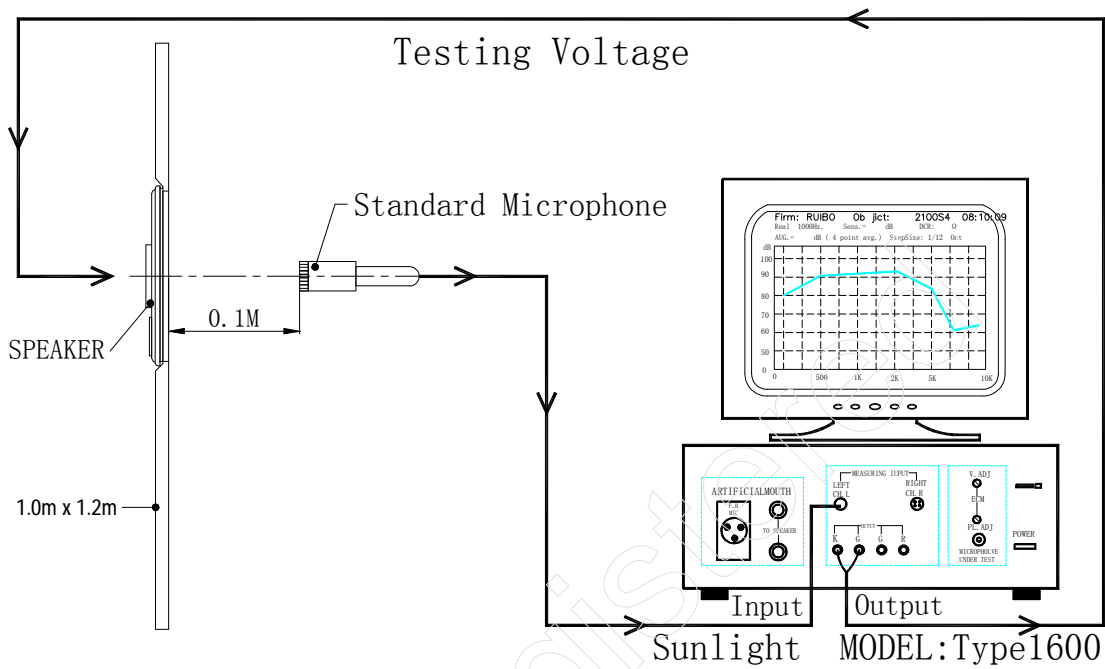

### 19. Test baffle Diagram

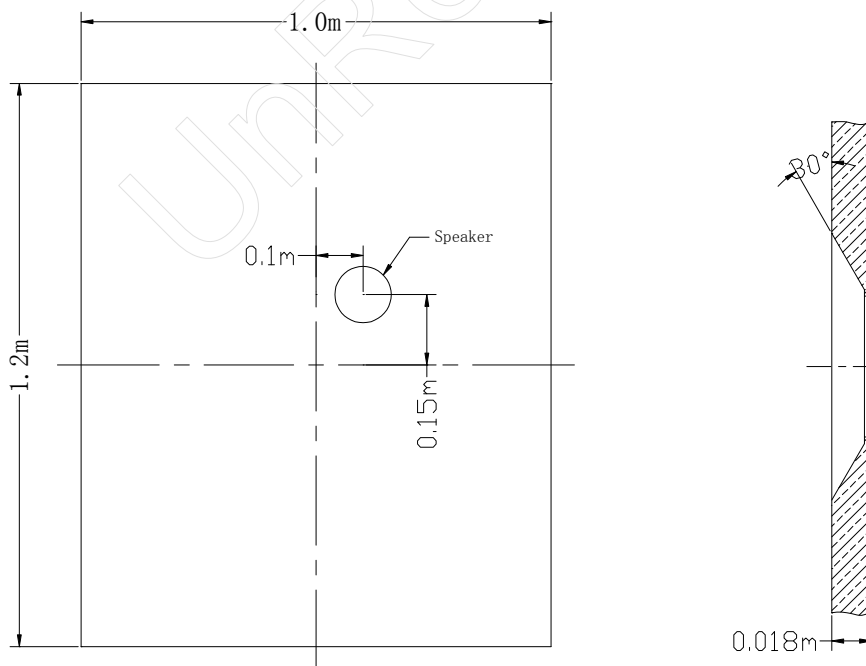

DATE	SPEC.NO	Version	Page
October 19.2012	SCM0284	A0	4/5



# DONGGUAN RUIBO ELECTRONIC CO., L.T.D.

## 东莞市瑞波电子有限公司

Dong Shan Guan Li Qu, Qishi Town, Dong guan City, Guangdong CHINA.

中國 廣東省 东莞市 企石镇 东山镇 永盛工业园

TEL: (86-769) 86572629 FAX: (86-769) 86572621

# SPECIFICATION

### 20. Frequency Resonance Fig (3).

Firm:1 Model:1 DATE:10-19-2012 TIME:09:44:29  
 Real 1000Hz Sens.= 97.4dB SPL Pass F.R.: Pass DCR: 8.25Ω Pass  
 Average SPL= 96.1dB SPL Pass (1000:1200:1500: 2000Hz) Sweep Speed: 1/12 Oct.

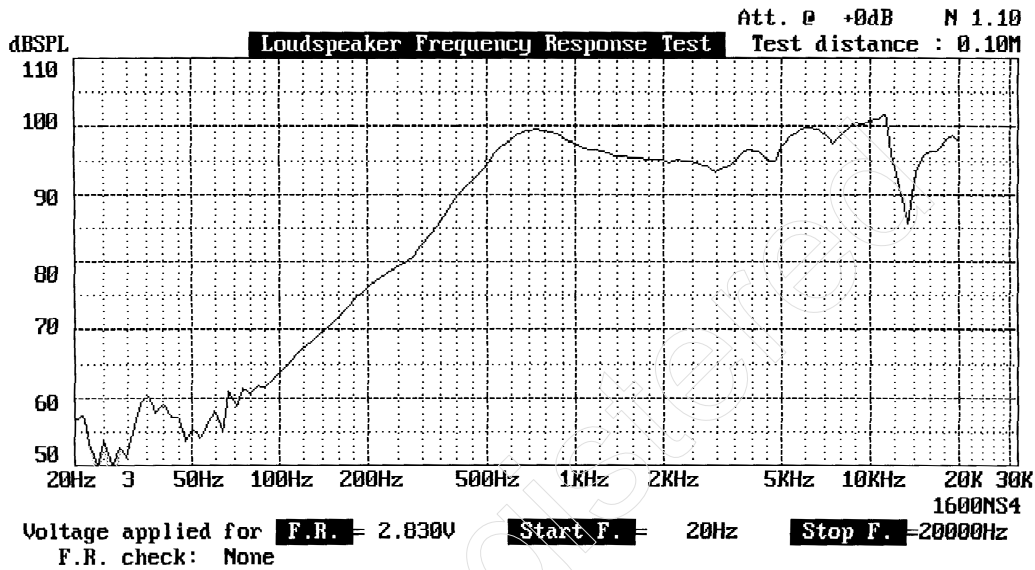

### 21. AC Impedance curve

Firm:1 Model:1 DATE:10-19-2012 TIME:09:42:55  
 Start Freq. = 20Hz Stop Freq. = 10000Hz Sweep Speed: 1/12 Oct.  
 ACV = 1.000V ACZ = 7.95 Ω @ 1504Hz. (Real)  
 Fo = 607Hz; Qm = 3.19; Qe = 8.97; Qt = 2.35; DCR = 7.69Ω.

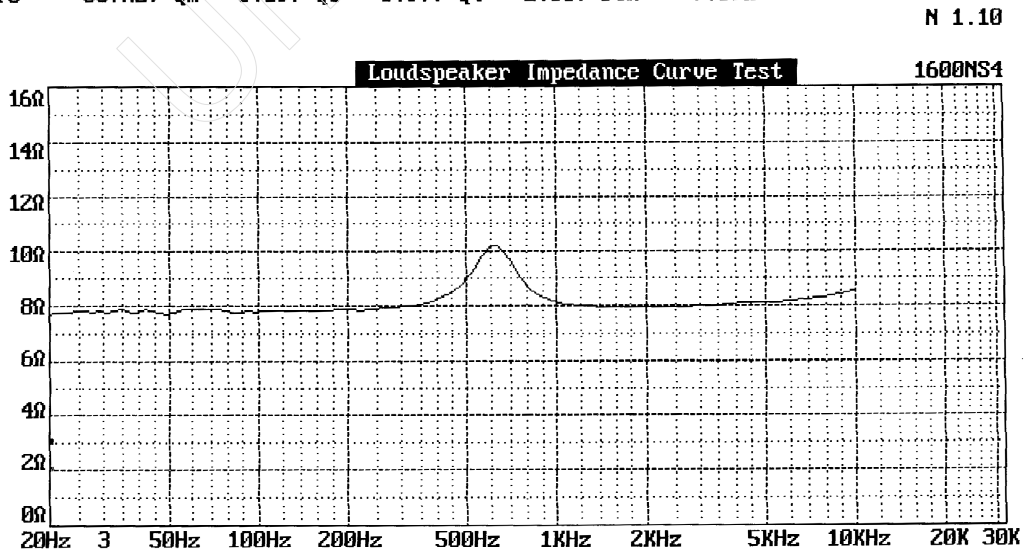

DATE	SPEC.NO	Version	Page
October 19.2012	SCM0284	A0	5/5