



Order Method:

Product name Hermaphroditic Blade and Receptacle Connector

Product type B03

Series No. No. of pole Color Customer Request
 — P — Beige —



See annex the technical drawing

Product Parameter:

Descriptions

The Hermaphroditic Blade and Receptacle connector is a new SMT connector and is intended for use with in-line board-to-board applications.

APPLICATIONS

- LED lighting modules
- Incandescent lighting strips
- Channel lettering

Electrical

Operating Current	6A
Operating Voltage	125VAC/125VDC
Dielectric Withstanding Voltage	1500 VAC

Materials

Contacts	Copper Alloy, tin over nickel plated
Housing	UL94-VO

MECHANICAL

Operating Temperature	-40°C to 105°C
-----------------------	----------------

KEY FEATURES

- Available in 2, 4, and 6 positions
- Single part to be stocked and placed onto pcb per position
- Connector mates and unmates horizontally and vertically
- Connector mates to itself
- Connector can be articulated from 90° to 180°
- Tape and reel packed for high speed SMT processes
- Low profile flat surface is compatible with SMT and reflow processing
- Rounded corners to minimize shadowing
- Solder pad footprint compatible with Electronics SMT Poke-In LED connector
- Redundant SMT pads

Board-to-Board Screw Down Jumper Assembly

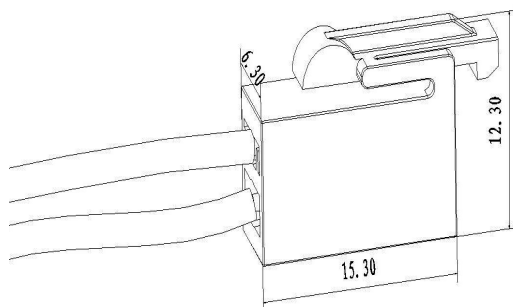
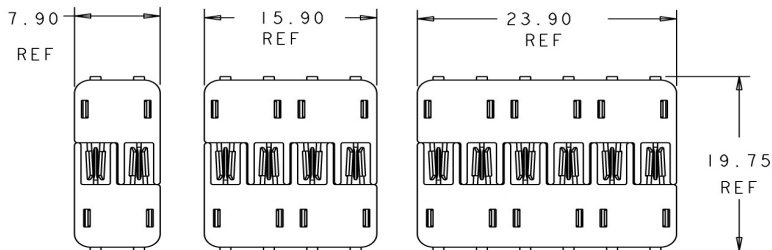
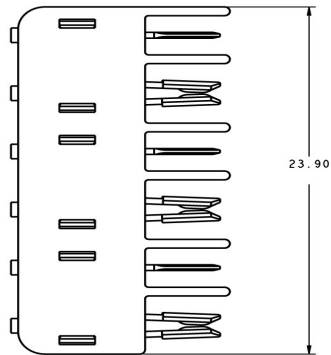
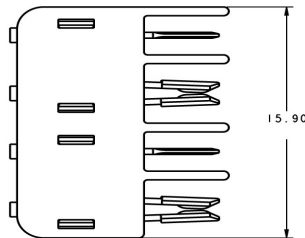
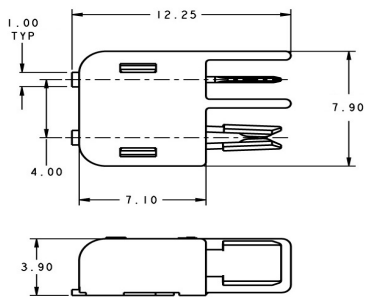
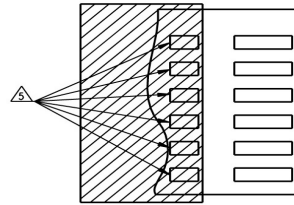
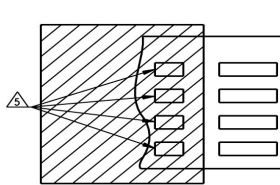
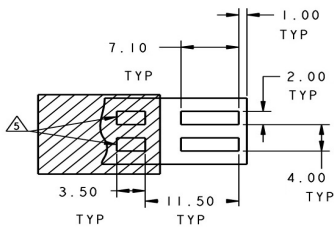

B03K