

Product Features

- High tin low calcium alloy grids designed to resist corrosion;
- Patent multi-layer polarity sealing structure, safety and reliable leakage-proof performance
- Patent composite grid structure and plate of high humidity and high temperature curing process which prolong life;
- High purity raw and auxiliary materials, low self discharge

Application

- UPS/EPS
- Emergency lighting
- Communication equipment;
- Renewable Energy
- Power tool
- Universal

Compliant Standards

- GB/T 19639.1-2005 ;
- IEC 61056-1/2: 2002
- JIS C8702-1/2 : 2009 ;
- Passed ISO9001、ISO14001、OHSAS18001、UL and CE certificates

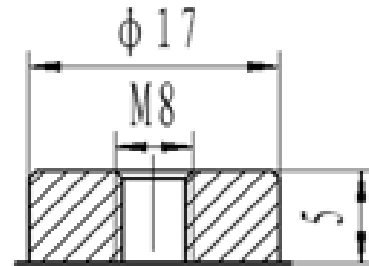
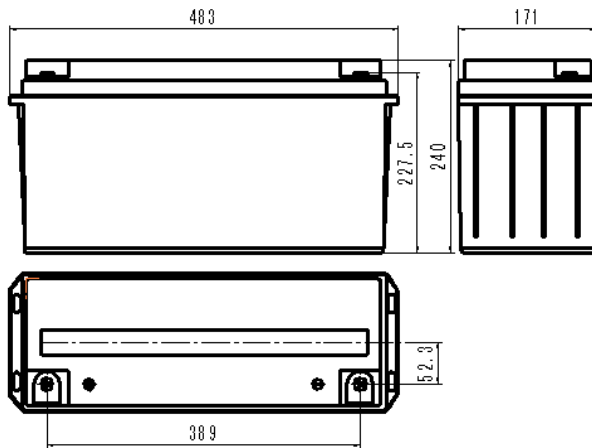

SP-30

Battery Model	ULL121500			
Designed Life	10 Years			
Capacity(25°C)	20HR(7.5A,1.75V)	10HR(13.95A1.75V)	5HR(25.5A,1.75V)	1HR(90.0A,1.70V)
	150AH	139.5AH	127.5AH	90AH
Dimensions	Length	Width	Height	Total Height
	483mm	171mm	240mm	240mm
Approx. Weight	42.5kg			
Internal Resistance	3.2mΩ			
Maximum Discharge Current	1500A(5 Sec.)			
Self Discharge	≤2% per months (25□)			
Charge Voltage(25□)	Cycle use		Float use	
	14.7V(-24mV/°C), max charge current:45A		13.62V(-18mV/°C)	

Discharge parameter:

Constant current discharge data (25°C , A)													
End voltage (V/cell)	5min	10min	15min	20min	30min	45min	1h	1.5h	2h	3h	5h	10h	20h
1.60	465.0	330.0	253.1	190.3	160.5	117.8	94.50	70.80	56.00	40.30	26.34	14.14	7.640
1.65	450.0	322.1	245.9	184.6	155.4	114.2	92.50	69.10	54.70	39.40	26.07	14.08	7.600
1.70	435.0	310.8	238.3	178.9	150.7	110.7	90.00	67.30	53.30	38.50	25.90	14.02	7.550
1.75	390.0	293.8	229.1	172.7	146.4	107.1	87.60	65.70	52.20	37.50	25.50	13.95	7.500
1.80	350.0	271.9	214.8	163.7	141.1	102.9	84.80	64.00	50.90	36.10	24.94	13.72	7.400

Constant power discharge data (25°C , W/cell)													
End voltage	5min	10min	15min	20min	30min	45min	1h	1.5h	2h	3h	5h	10h	20h
1.60	760.0	560.0	450.5	333.9	275.4	202.0	166.4	132.9	104.5	75.90	49.45	28.29	15.30
1.65	742.0	546.6	439.1	325.3	267.9	197.1	163.7	130.5	103.0	75.14	49.00	28.19	15.27
1.70	705.0	528.6	424.1	315.3	261.4	192.6	161.0	129.0	101.7	74.44	48.56	28.07	15.22
1.75	655.0	504.0	407.9	303.7	252.3	188.7	157.3	126.6	100.0	73.71	48.12	27.95	15.15
1.80	589.0	472.3	387.9	290.7	244.1	183.3	152.5	123.3	98.50	72.60	47.50	27.65	15.02

Performance Curve :

