

SIGN	DATE	DESCRIPTION	APPROVER
△			
△			
△			

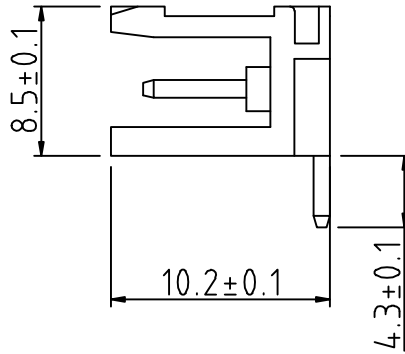
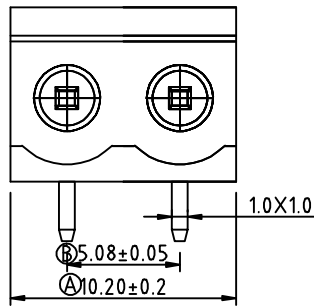
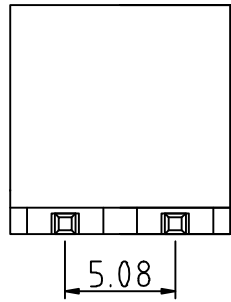

Technical Data:

Material:

- Solder Pin: Brass with Tin plated
- Insulator body(housing): Polyamide(Glass filled)(UL94V-0)

Electrical

- Voltage rating: 300VAC
- Current rating: 8A
- Insulation resistance: 500MΩ at DC 500V
- Withstanding Voltage: AC 1500V(1min)

Mechanical:

- Using temperature Range: -30°C to +105°C
- Soldering temperature: +250°, 5seconds Max.

N=Number of contacts
P.C.B. LAYOUT

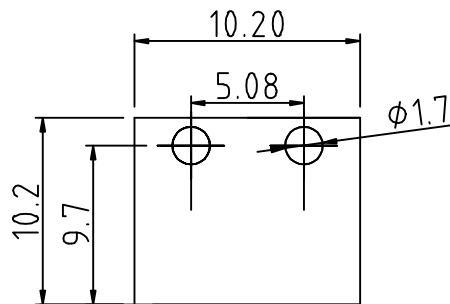

KLS ELECTRONIC CO., LTD

PART NAME: L-KLS2-EDFR-5.08-XXP-4				TITLE:	
PART NO.:				DWG NAME:	
APPROVED BY	CHECKED BY	DESIGNED BY	DRAWN BY	CUSTOM NO.:	Tolerance X. ±0.50 X.X ±0.30 X.XX ±0.10 X° ±1°
岑杰		孙学丰		UNITS: mm	
				SCALE: 4/1	
				REVISION: B1	