

FEATURES

- ※Sealed IP67
- ※Reflow solderable
- ※Dust proof with high reliability

APPLICATION

- ※Audio, OA equipment
- ※Instrumentation, Communication
- ※White goods

SPECIFICATION

| | |
|-----------------------|---|
| Contact Rating | 50mA, 12V DC |
| Contact Resistance | 100mΩ max. |
| Insulation Resistance | 100MΩ min. 500V DC |
| Dielectric Strength | 250V AC/1 minute |
| Operating Force | 160±50gf, Brown(N) 66/677 160±50gf, Silver(S) 68 180±50gf, Brown(N) 69/67/65/64 260±70gf, Red(R) 69/67/66/65/64 360±90gf, Transparent(T) 69/67/65/677 |
| Travel | 0.25mm 68S/66N/66R/677 0.45mm (69/67N,R)(65/64N,R,T) 0.6mm 69/67T |
| Operating Life | 100,000 cycles min. for 68/66/677 500,000 cycles min. for 69/67/65/64 |
| Operating Temp. | -25°C ~ +70°C |
| Storage Temp. | -30°C ~ +80°C |

HOW TO ORDER

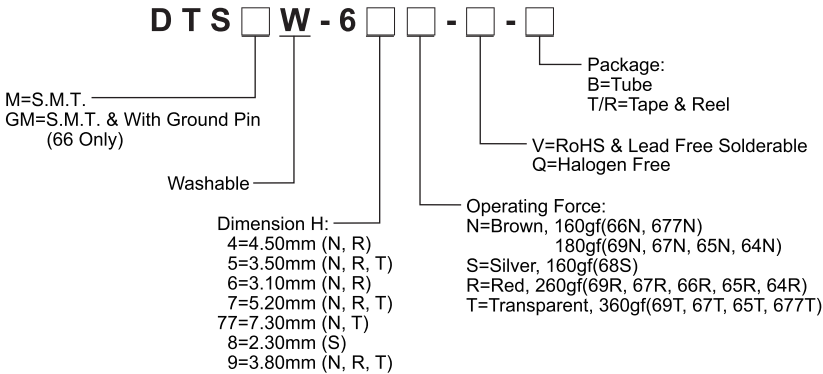

CIRCUIT

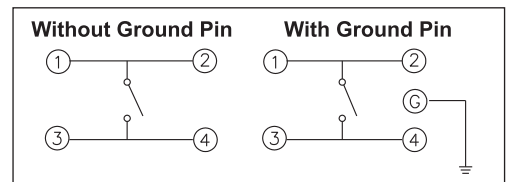

PACKAGE

- <Tube>
75 pcs
- <Tape & Reel>
DTSGMW-66: 2000 pcs
DTSMW-68, 66: 2000 pcs
DTSMW-69, 65: 1900 pcs
DTSMW-67, 64: 900 pcs
DTSMW-677: 650 pcs

DTSGMW-66

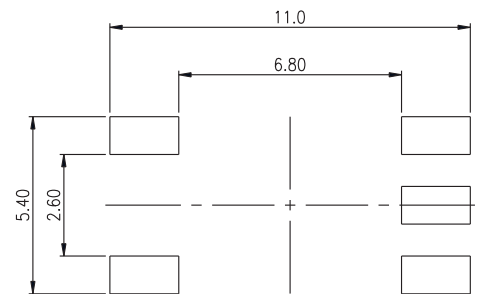
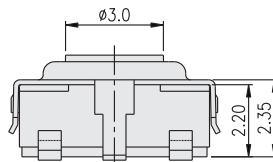
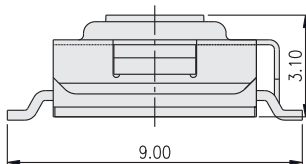
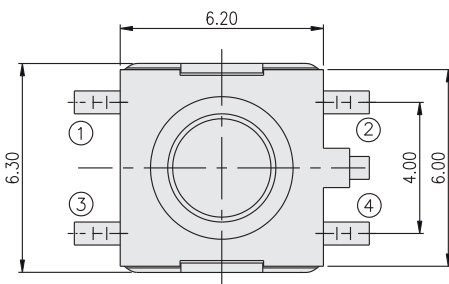

P.C.B. LAYOUT

TACT SWITCH

DTSMW-68

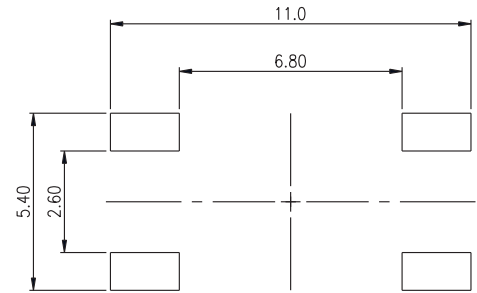
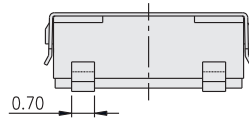
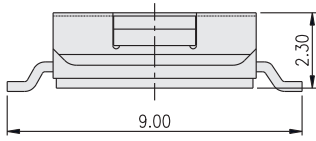
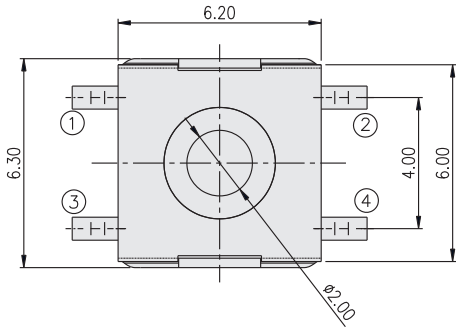

P.C.B. LAYOUT

TACT SWITCH

DTSMW-6 □

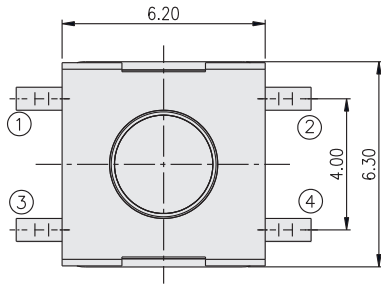

| PART NO. | H |
|-----------|------|
| DTSMW-64 | 4.50 |
| DTSMW-65 | 3.50 |
| DTSMW-67 | 5.20 |
| DTSMW-69 | 3.80 |
| DTSMW-677 | 7.30 |

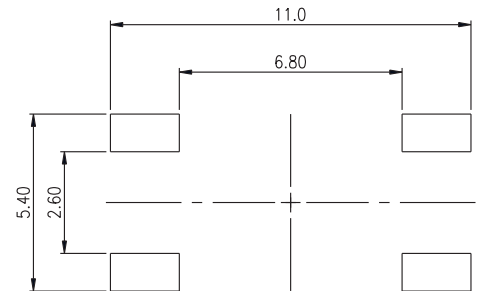
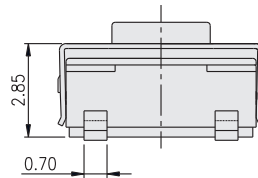
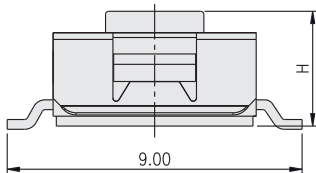

P.C.B. LAYOUT