



# Xitanium Constant Current Xtreme

Xitanium 150W 0.70A 230V sXt

Xitanium Xtreme LED drivers provide constant current output, optimal for a single string of LEDs. With exceptional operating efficiency, our drivers significantly reduce energy costs. The Xitanium Xtreme portfolio offers both central and standalone dimming protocols further increasing the energy savings and CO2 reductions achieved with LED lighting. The fully programmable drivers deliver all dimming options and a range of currents in a single driver. System reliability is maximized with intelligent temperature monitoring of the LED light engine. The full portfolio offers maximum flexibility with customizable operating settings, delivering optimal performance tailored for each design.

## Product data

### • General Information

Number Of Products On MCB (16A Type B) (Max)	6
--	---

### • Operating and Electrical

Input Frequency	50 to 60 Hz
Total Harmonic Distortion IEC (Max)	20 %
Output Current Ripple (Nom)	25 %
Maximum Efficiency	92 %
Power Factor 100%	0.98
Load (Min)	
Output Current (Nom)	700 mA
Output Current Tolerance (Max)	5 %
Output Current Tolerance (Min)	-5 %
Input Voltage (AC)	220-240 V
Power Factor 50%	0.96
Load (Min)	
Earth Leakage Current (Max)	0.7 mA
Input Current (Max)	690 mA
Input Power (Nom)	165 W
Inrush Current Peak (Max)	130 A
Output Power (Nom)	42-150 W
Output Voltage	60-210 V

Inrush Current Width To 50% Of Peak	165 $\mu$ s
-------------------------------------	-------------

### • Wiring

Output Wire Length	280 mm
Output Wire Cross Section (Nom)	0.82 mm <sup>2</sup>

### • Temperature

T-Ambient (Max)	55 °C
T-Ambient (Min)	-40 °C
T-Case Lifetime (Nom)	67 °C
T-Case Maximum (Max)	80 °C
Module Temperature Protection	-
T-Case Switch Off (Nom)	80 °C

### • Controls and Dimming

Control Interface	None
Lumistep Dimming Time	-
Lumistep Dimming Time After Midpoint	-

### • Mechanical and Housing

Housing Color	Black
---------------	-------

**PHILIPS**

## • Approval and Application

Surge Protection (Common/Differential)	3/3 kV
IP Classification	IP 66 [ Ingress Protection 66]
Isolation Classification	Class II
Approval Marks	ENEC certificate CE marking RoHS compliance

## • Product Data

Full product code	872790080917600
Order product name	Xitanium 150W 0.70A 230V sXt
EAN/UPC - Product	8711500880239
Order code	913710859002
Numerator - Quantity Per Pack	1
Numerator - Packs per outer box	10
Material Nr. (12NC)	913710859002
Net Weight (Piece)	0.635 kg

## Dimensional drawing

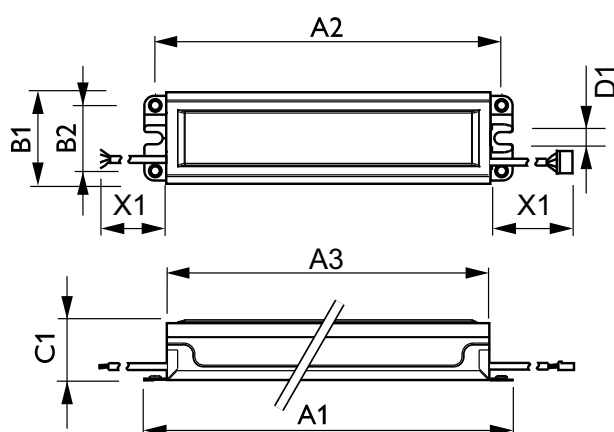

Xitanium 75 & 150 W sXt

## Xitanium 150W 0.70A 230V sXt

Product	D1	A2	B2	C1	A1	A3	X1	B1
Xitanium 150W 0.70A 230V sXt	8 mm	226.2 mm	42.9 mm	37.1 mm	240.5 mm	211.1 mm	280 mm	59.1 mm

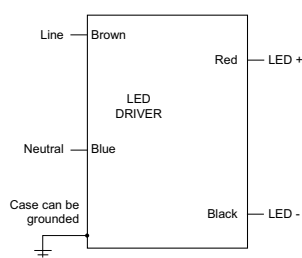

Xitanium 150W 0.35 & 0.70A sXt



© 2015 Philips Lighting Holding B.V.  
All rights reserved.

Specifications are subject to change without notice. Trademarks are the property of Koninklijke Philips N.V. (Royal Philips) or their respective owners.

[www.philips.com/lighting](http://www.philips.com/lighting)

2015, December 23  
data subject to change