

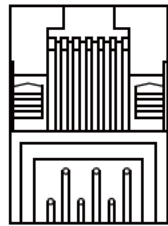

## Modular Jack Side Entry H=11.5 W=18.1

### Material & Finish

Housing: P.B.T, UL 94V-0  
 Contact :0.45mm Thickness Phosphor Bronze,  
 Gold Plated Over Nickel on Contact Area.

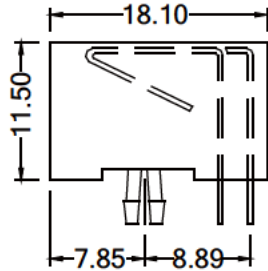
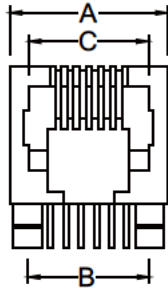

Position	Contacts	A	B	C
4P	4C	11.00	7.62	7.90
6P	2C/4C/6C	13.20	10.16	9.90
8P	8C	15.30	11.43	12.00

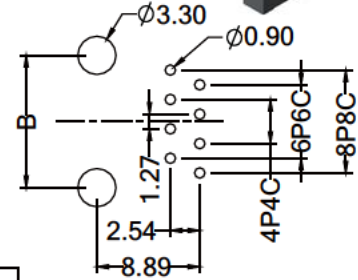
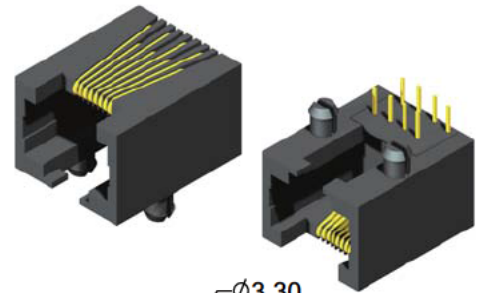

Recommended PCB Layout  
 (PCB TOLERANCE ±0.05)

### Order Information

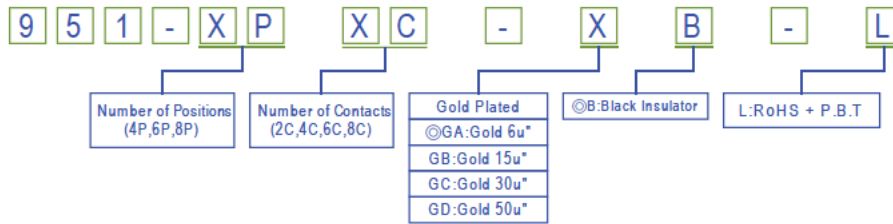

## Modular Jack Side Entry SMT Type H=11.5 W=18.2

### Material & Finish

Housing: P.B.T or Nylon 9T, UL 94V-0  
 Contact :0.35mm Thickness Phosphor Bronze,  
 Gold Plated Over Nickel on Contact Area,  
 Tin plated over Nickel on solder area.

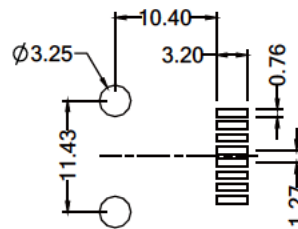
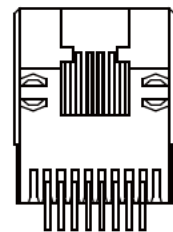
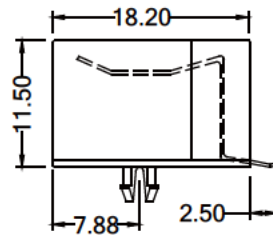

Recommended PCB Layout  
 (PCB TOLERANCE ±0.05)

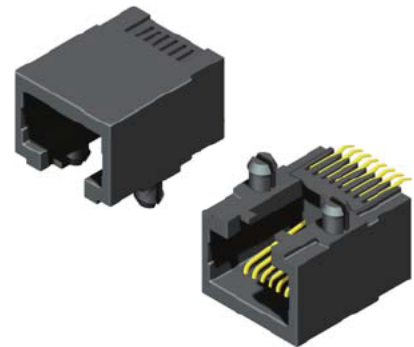

### Order Information

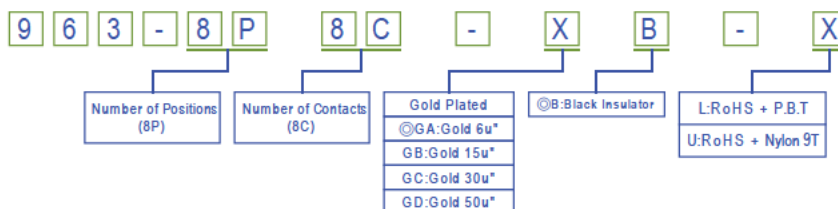

Modular Jack



RoHS