

PushPull acc. to IEC 61076-2-010

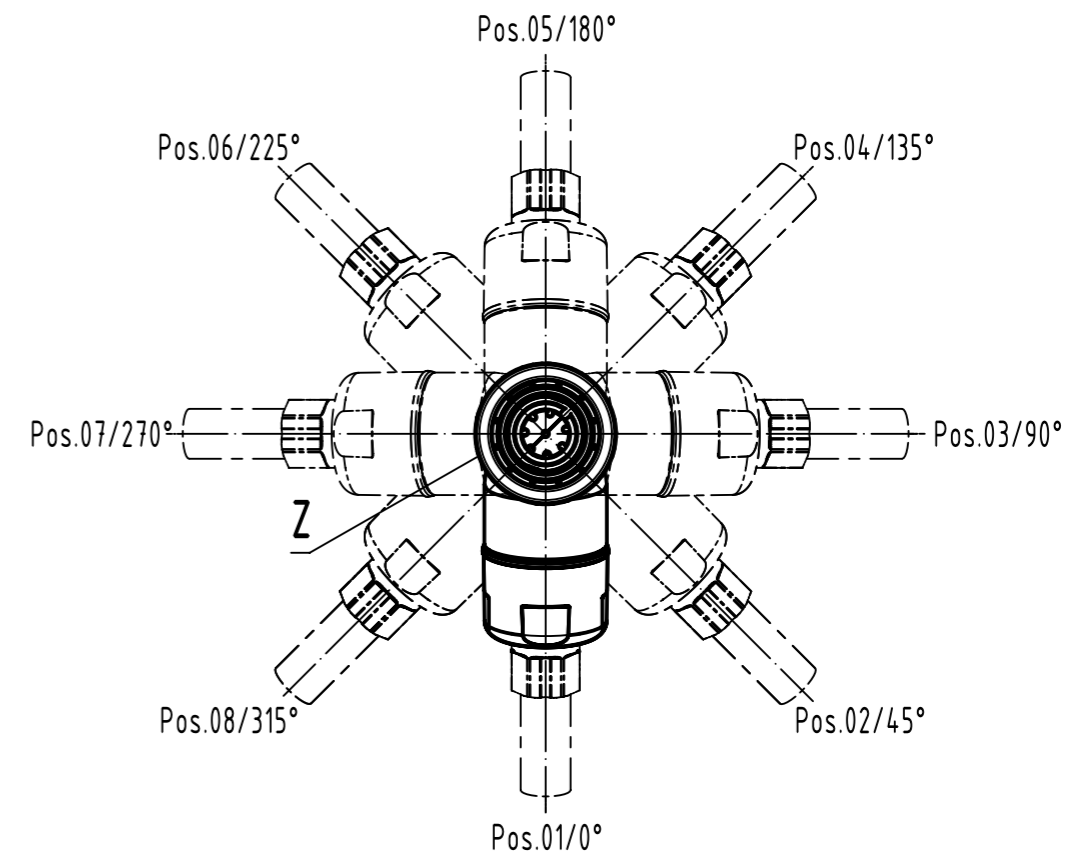

assembly aid enclosed



Z (2:1)
contact face acc. to IEC 61076-2-101

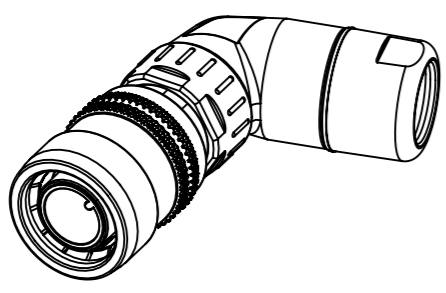
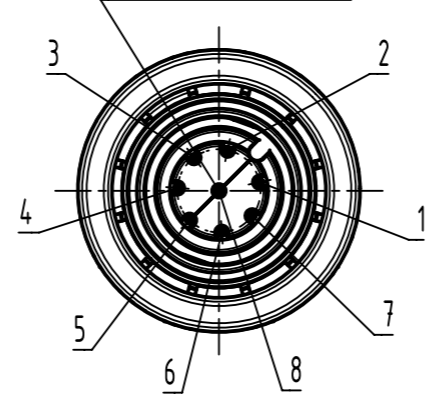

order contacts separately

| | |
|------------|-----------------|
| wire gauge | part-no contact |
| AWG 26-23 | 21 01 100 9020 |

| | | | | | | |
|------------------------------|---|--|--------------------------|----------------------------|--------------------|---|
| | All rights reserved Department EL PD | All Dimensions in mm Original Size DIN A3 | Scale 1:1 | Free size tol. | | Ref. |
| | | Created by SERBANA | Inspected by FARCASIU | Standardisation RUETERA | Date 2023-07-07 | State Final Release |
| HARTING D-32339 Espelkamp | | Title M12-PP-CC-CRIMP-8P-ACOD-M-ANG-CF | | | | Doc-Key / ECM-Nr. 100765315/UGD/002/E 50000227072 |
| | | Type TB | Number 21038213833 | | Rev. E | Page 1/1 |