

A-A (2:1)

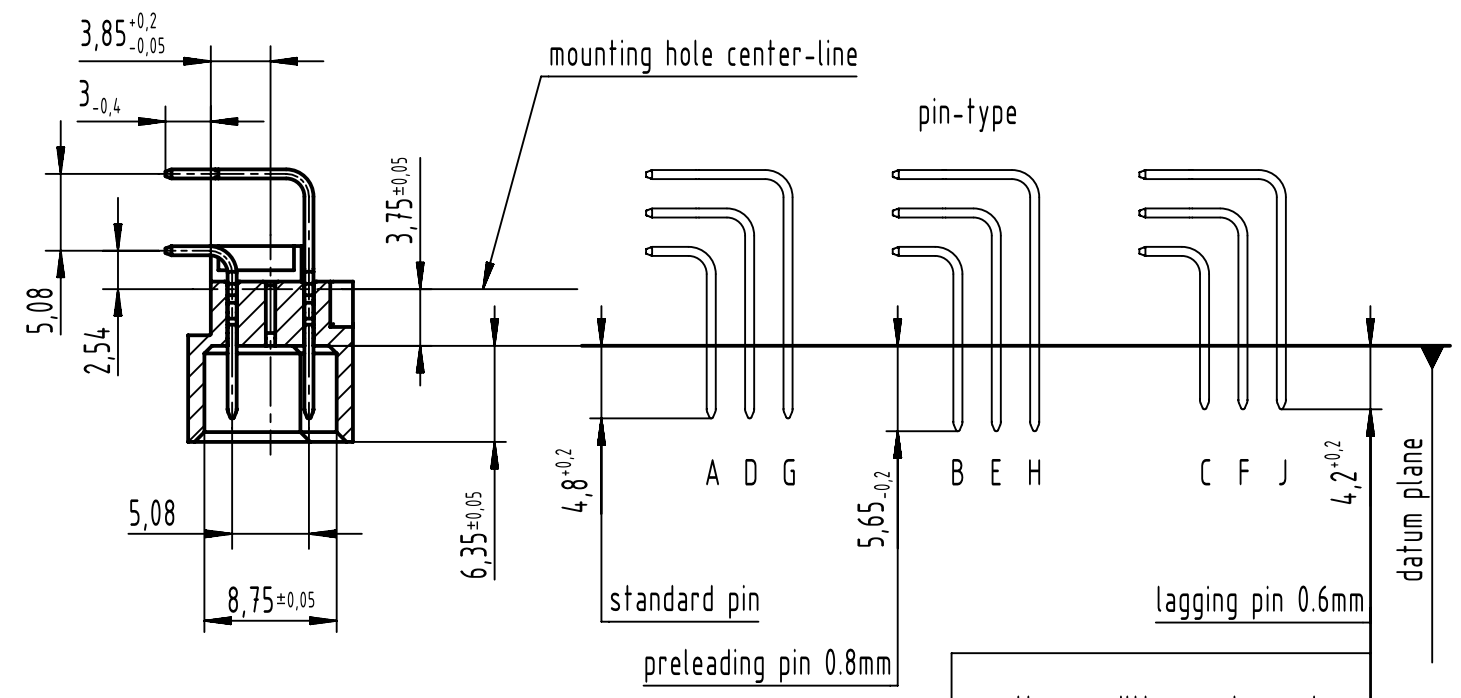

mating conditions not acc. to IEC 60603-2

C
contact loading

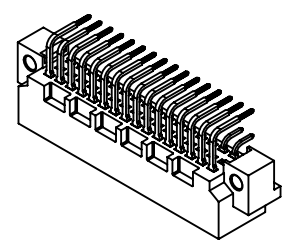
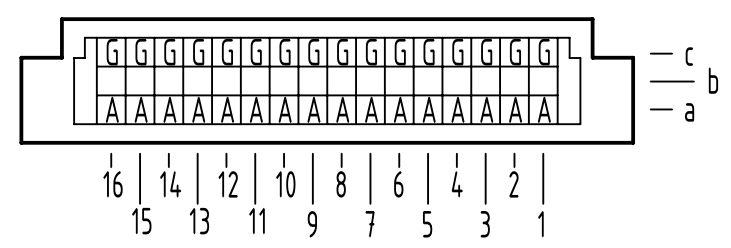

further information see product data sheet

09 23 132 6919	2
part no.	performance level

All rights reserved Department EL PD HARTING D-32339 Espelkamp	All Dimensions in mm Original Size DIN A3	Scale 1:1	Free size tol. IEC 60603-2	Ref. Sub. TB 09 23 132 x919 / Mod. 35345 / 24.10.2008
	Created by STORCK	Inspected by LEHNERT	Standardisation	Date 2021-07-23
Title DIN Signal type 2C male solder angled THR 32-pole				Doc-Key / ECM-Nr. 100072926/UGD/022/C 500000198549
Type TB		Number 0923132X919		Rev. C Page 1/1