

A
contact arrangement

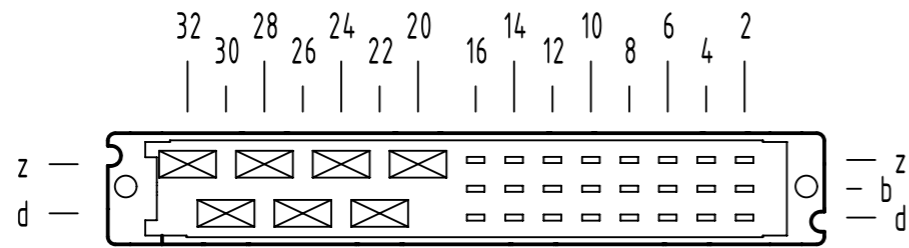

7 faston - contacts

☒ = position with contacts

☐ = position without contacts

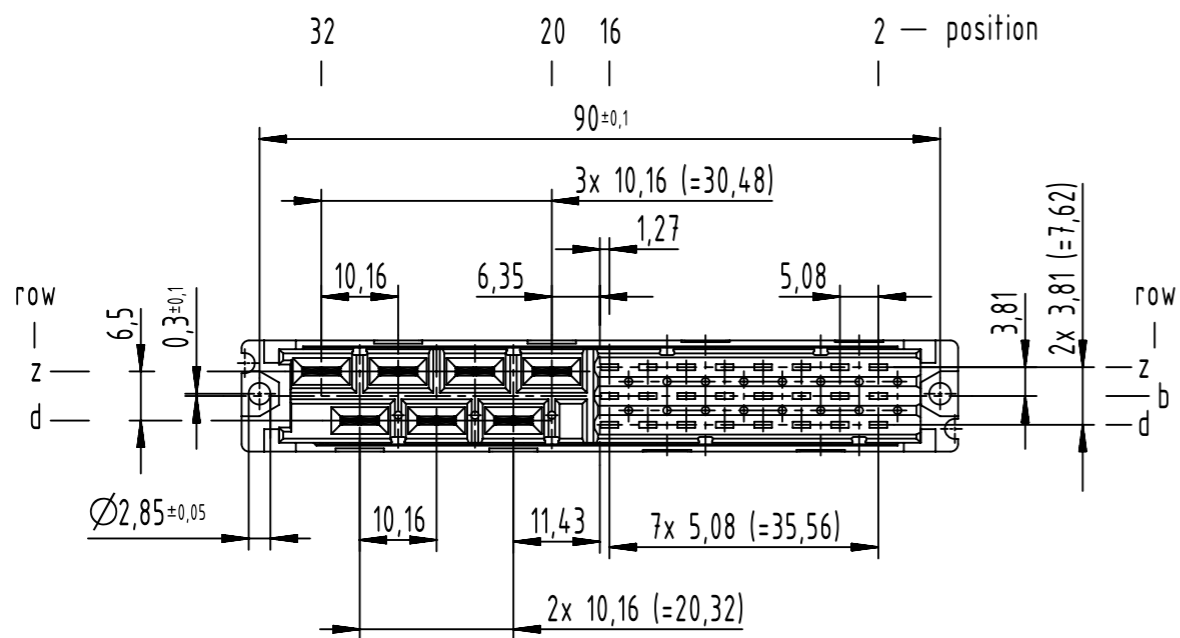
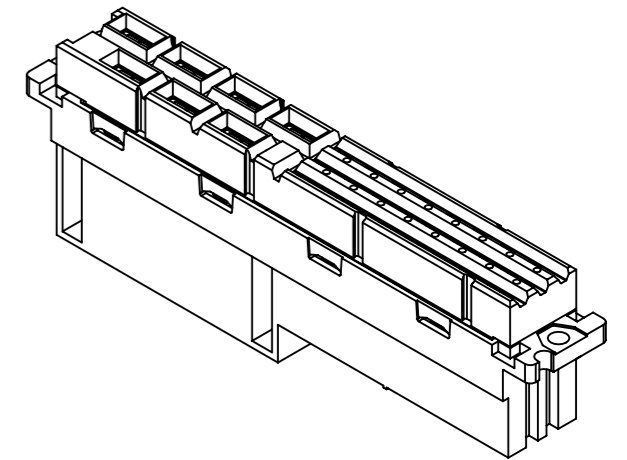
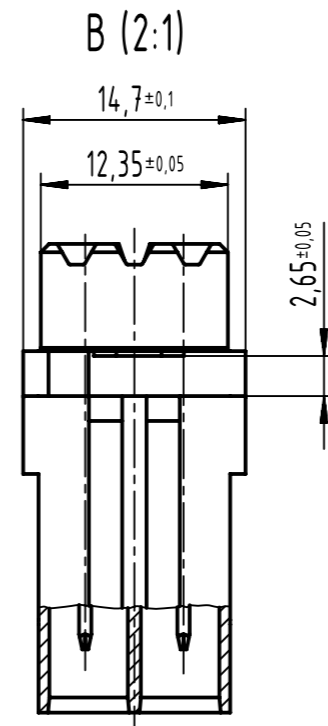
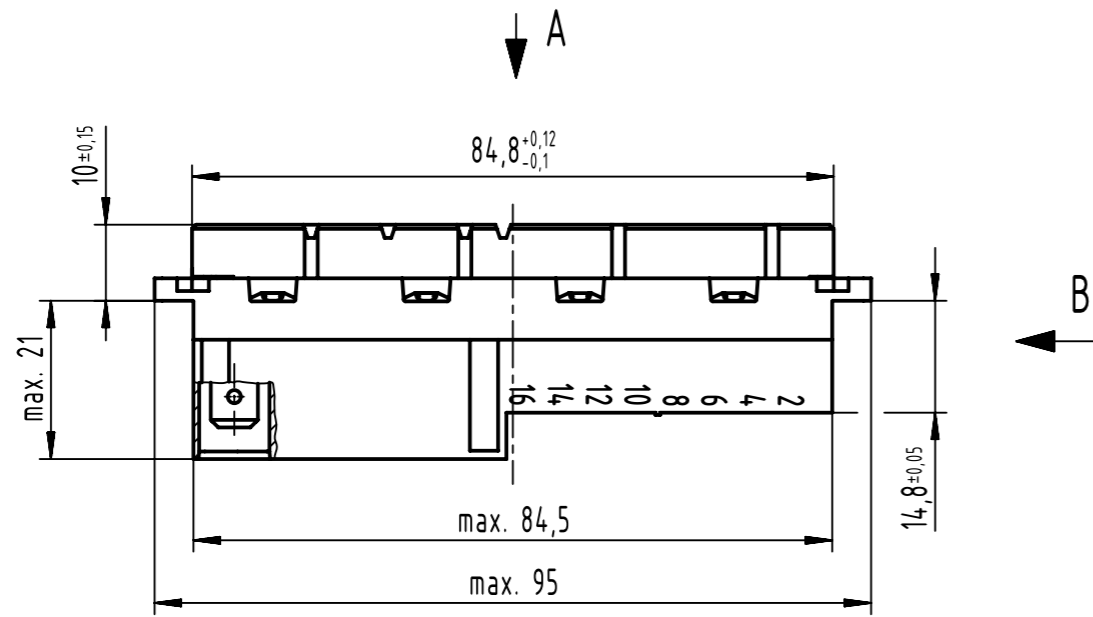

further information see product data sheet

contact surface Ag

① for faston 6,3x0,8 female contact
acc. to DIN 46245 and DIN 46247

	All rights reserved Department EL PD	Created by STORCK	Inspected by LEHNERT	Standardisation SAP_WFRT	Date 2022-03-08	State Final Release	Ref. Sub. TB 09 06 231 2881 222 36440 11.10.2011
	HARTING D-32339 Espelkamp	Title DIN Power type MH female conner faston crimp NFF			Doc-Key / ECM-Nr. 100072874/UGD/007/C 500000213301		Rev. C Page 1/1