

1  
RoHS Compliance

Needle Bar

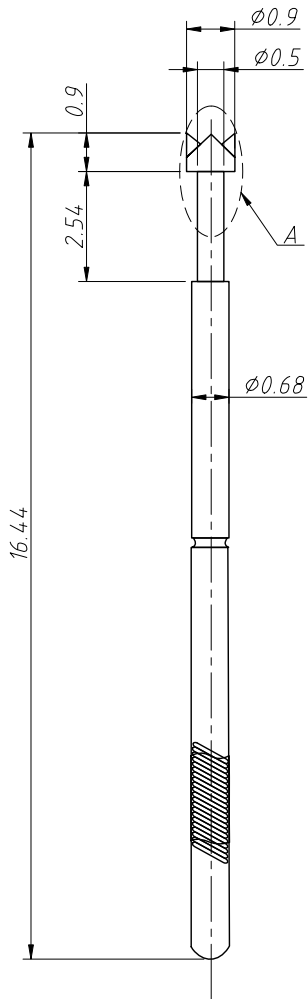

Bushing

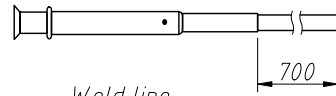
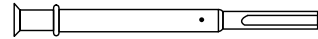
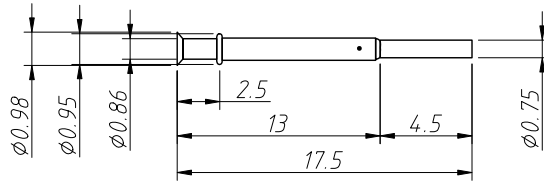

Weld line

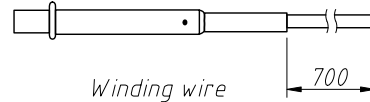
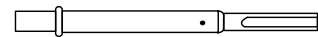
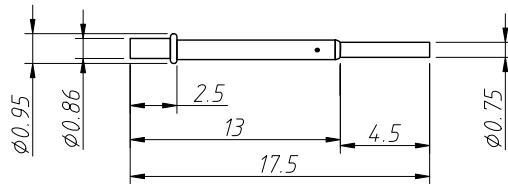

Winding wire

Notes:

1.Material:

Needle Bar:Imported Copper Plating Or Rhodium Or Gold Plating After Heat Treatment Of Imported SK4  
Needle Tubing:Phosphor Bronze,Gold Plated  
Bushing:Phosphor Bronze,Gold Plated  
Spring:Stainless Steel

2.Electric:

Drill Size:0.9mm  
Rated Current:3A  
Rated Resistance:50mΩ  
Compaction Elasticity:120g(75g,30g)  
Max Travel:2.54mm

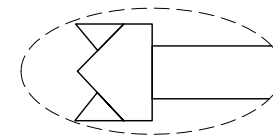

Detail A  
2:1

ANGLE TOLERANCE	PROJECTION	Description:	Probe Pin	
±3°				
GENERAL TOLERANCE	UNITS	mm	KLS P/N:	L-KLS1-P13-4023-G
x.x ±0.30	SHEET SIZE	A4	XX	
x.xx ±0.20	Draw:	Daniel	2023-07-04	NingBo KLS ELECTRONIC CO.,L TD.
x.xxx ±0.10	Check:	Daniel	2023-07-04	