

REV	CONTENT	CHK	DATE
V0.0	CONTENT	YL	23.06.07

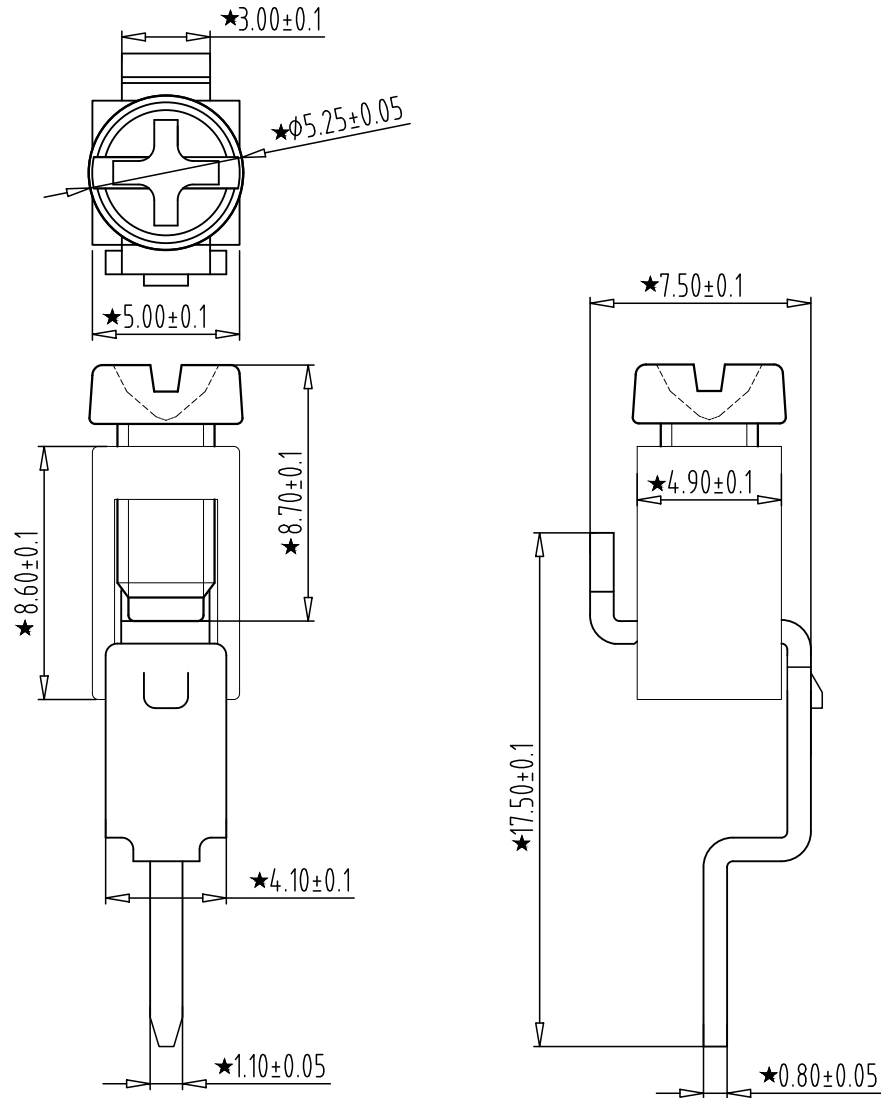

Electrical :

- | | | |
|--|----------------|------------------------|
| | UL | IEC |
| 1. Rated Voltage : | 300V | 450V |
| 2. Rated Current : | 30A | 24A |
| 3. Torque Value : | M3 , 4.43Lb.in | M3 , 0.5N.m |
| 4. Wire Range: | 26-10AWG | 1.5-4.0mm ² |
| 5. Operating Temperature : | -40°C~+105°C | |
| 6. RoHS Compliance | | |
| 7. "★" is the key quality control point. | | |

Total Pitch Tolerances in mm										Nominal dimension range in mm										⊥	=	-	//								
over	over	over	over	over	over	over	over	over	over	over	over	over	over	over	over	over	over	over	over	over	over	over	over	over	over	over	over	over	0	100	150
0	30	53	70	90	115	150	250	350	500	0	30	53	70	90	115	150	200	250	320	0	10	all	0	100	150	0	100	150			
±0.18	±0.20	±0.25	±0.3	±0.35	±0.44	±0.60	±0.70	±0.85	±0.20	±0.25	±0.30	±0.35	±0.44	±0.55	±0.70	±0.80	±0.90	0.2	0.3	0.3	0.3	0.2	0.3	0.5							

3	SCREW	XX	1	STEEL	Zn Plated
2	BLOCK	XX	1	BRASS	Ni Plated
1	PIN	XX	1	BRASS	Tin Plated
ITEM	NAME OF PART	NO. OF PART	Q'TY	MATERIAL	NOTE
DWG.	YL	DATE	23.06.07	SIZE	A4 UNITS mm SHEET/OF 1 / 1
CHK.	DATE			SCALE	1:1
APP.	DATE			NAME	K12-00
Golten 宁波冠泰电子有限公司 NINGBO GOLTEN ELECTRONICS CO., LTD.				DWGNO.	XXXX